



GLOBE GEARED VANE AIR MOTORS

The GLOBE geared vane air motors are available with a standard range of worm and coaxial gearboxes. They generate high torques and low speeds of rotation required in many applications. Power ranges up to 8.3kW/11,1HP at 6 bar/90psi air pressure.

The motor and gearbox are directly mounted onto each other, making them compact and resistant against the environment. GLOBE geared vane air motors are designed for smooth operation and are commonly used in mixing equipment, conveyor belts, hoists and winches, hose reels and turntables.

GLOBE geared vane air motors have many advantages including:

- Power ranges up to 8.3kW/11,1HP at 6 bar/90psi air pressure
- High nominal torque up to 1650Nm/1216 lbs.ft
- Speed of rotation as low as 7 rpm
- Easily variable and controllable speed and torque
- Perfect for applications in hazardous and aggressive environments
- ATEX certification ATEX II cat. 2 G&D T5 on request
- No damage by overload or repeated starting
- Can be used in stall conditions
- Superior power to weight ratio
- Instantly reversible
- Minimum maintenance
- High radial and axial loads permitted
- Oil free possible

Please contact GLOBE for special requests. We are known for our custom solutions.

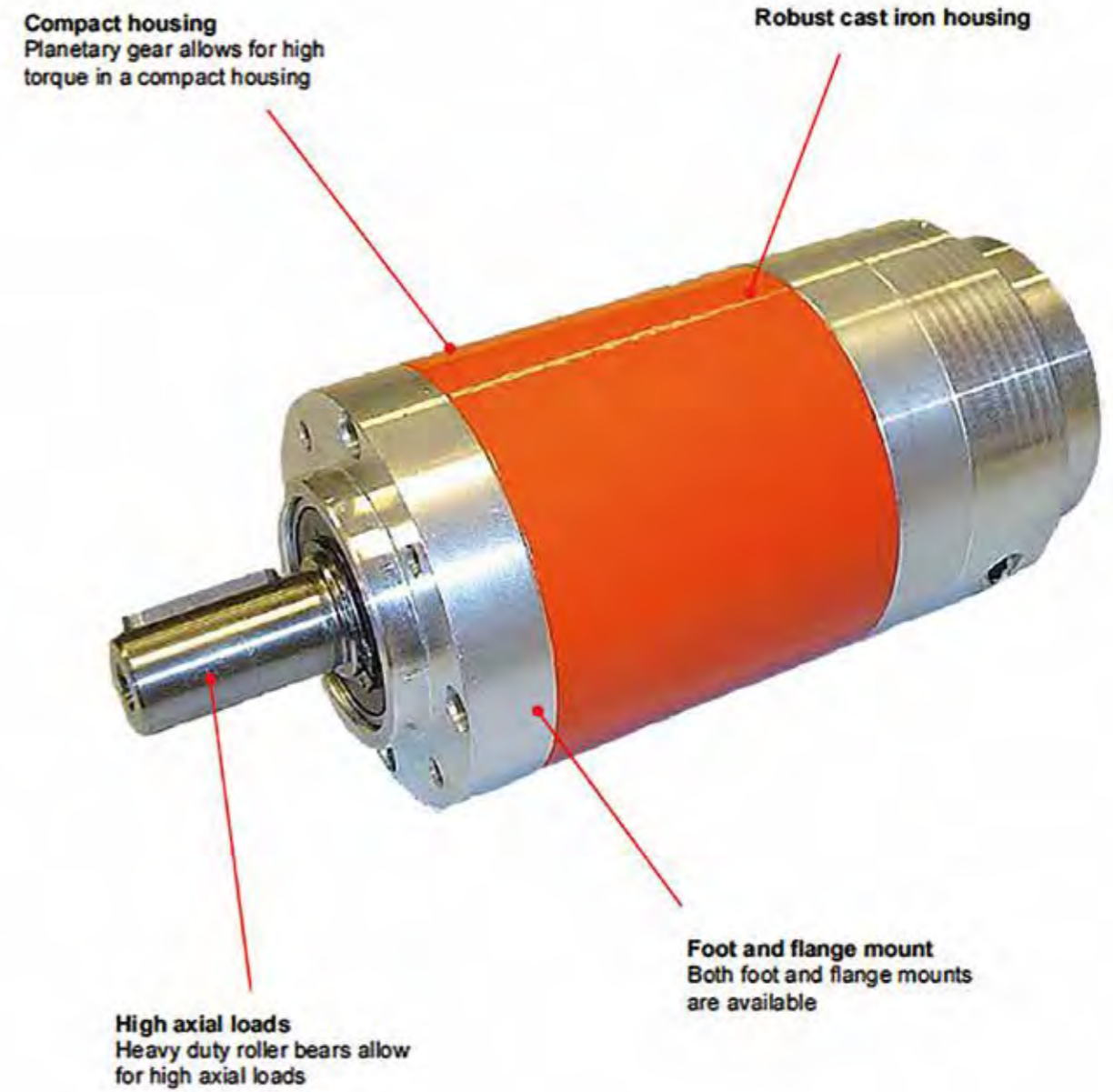
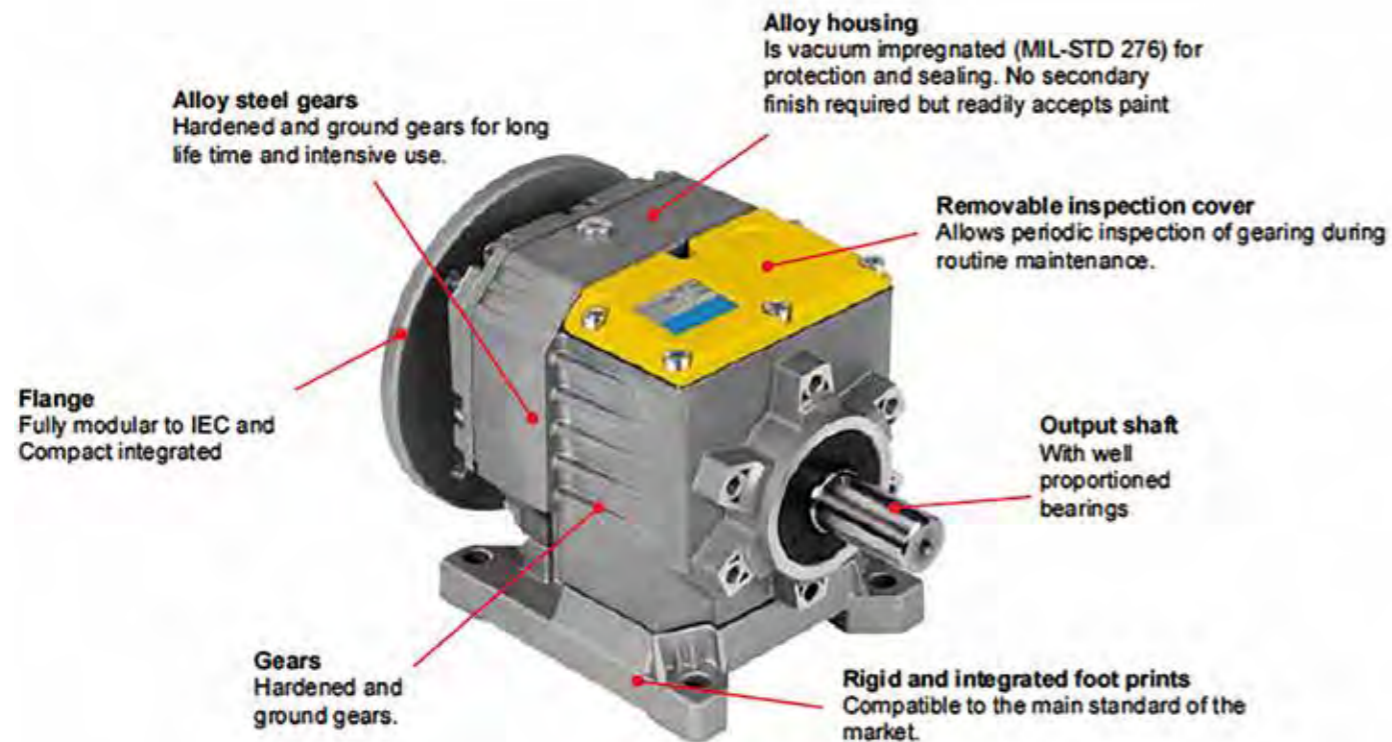
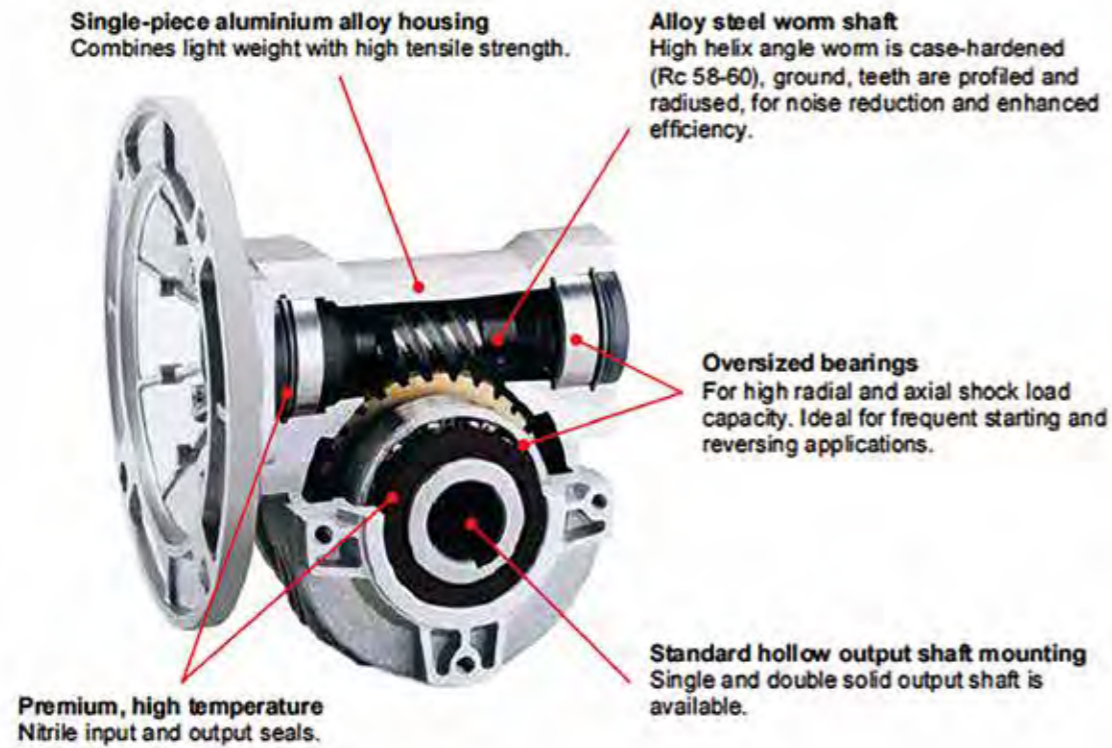

PERFORMANCES GLOBE VANE AIR MOTORS WORM GEARBOX

Ordering code flange model	Ordering code foot model	i	Power* (kW / hp)	Max. rpm**	Nominal torque* (Nm / lb-ft)	Min. starting torque (Nm / lb-ft)	Weight flange model (Kg / lb)	Weight foot model (Kg / lb)
-------------------------------	-----------------------------	---	---------------------	---------------	------------------------------------	---	-------------------------------------	-----------------------------------

GLOBE V4 + worm gear

VS4DW63FG7	VS4DW63BG7	7	1.3kW / 1.8hp	430	30Nm / 22lb-ft	20Nm / 15lb-ft	11Kg / 24.2lb	12Kg / 26.4lb
VS4DW63FG15	VS4DW63BG15	15	1.3kW / 1.8hp	200	61Nm / 45lbs-ft	35Nm / 26lb-ft	11Kg / 24.2lb	12Kg / 26.4lb
VS4DW63FG30	VS4DW63BG30	30	1.2kW / 1.6hp	100	110Nm / 81lb-ft	53Nm / 39lb-ft	11Kg / 24.2lb	12Kg / 26.4lb
VS4DW63FG45	VS4DW63BG45	45	1.1kW / 1.5hp	65	155Nm / 114lb-ft	67Nm / 49lb-ft	11Kg / 24.2lb	12Kg / 26.4lb
VS4DW85FG67	VS4DW85BG67	67	1kW / 1.3hp	45	210Nm / 155lb-ft	80Nm / 59lb-ft	17Kg / 37.4lb	19Kg / 41.8lb
VS4DW85FG74	VS4DW85BG74	74	0.9kW / 1.2hp	40	220Nm / 162lb-ft	83Nm / 61lb-ft	17Kg / 37.4lb	19Kg / 41.8lb

GLOBE V6 + worm gear

VS6DW63FG7	VS6DW63BG7	7	2.7kW / 3.7hp	430	60Nm / 44lb-ft	40Nm / 29lb-ft	17Kg / 37.4lb	18Kg / 39.6lb
VS6DW63FG15	VS6DW63BG15	15	2.6kW / 3.5hp	200	120Nm / 88lb-ft	70Nm / 52lb-ft	17Kg / 37.4lb	18Kg / 39.6lb
VS6DW85FG28	VS6DW85BG28	28	2.5kW / 3.4hp	105	220Nm / 162lb-ft	110Nm / 81lb-ft	23Kg / 50.6lb	25Kg / 55lb
VS6DW85FG46	VS6DW85BG46	46	2.3kW / 3.1hp	65	330Nm / 243lb-ft	160Nm / 118lb-ft	23Kg / 50.6lb	25Kg / 55lb
VS6DW110FG64	VS6DW110BG64	64	2.3kW / 3.1hp	47	460Nm / 339lb-ft	195Nm / 144lb-ft	39Kg / 85.8lb	44Kg / 96.8lb
VS6DW110FG84	VS6DW110BG84	84	2.2kW / 3.0hp	35	575Nm / 424lb-ft	220Nm / 162lb-ft	39Kg / 85.8lb	44Kg / 96.8lb

GLOBE V8 + worm gear

VS8DW85FG7	VS8DW85BG7	7	4kW / 5.4hp	430	90Nm / 66lb-ft	75Nm / 55lb-ft	24Kg / 52.8lb	26Kg / 57.2lb
VS8DW85FG14	VS8DW85BG14	14	3.9kW / 5.3hp	215	175Nm / 129lb-ft	125Nm / 92lb-ft	24Kg / 52.8lb	26Kg / 57.2lb
VS8DW110FG30	VS8DW110BG30	30	3.7kW / 5.0hp	100	350Nm / 258lb-ft	200Nm / 147lb-ft	40Kg / 88lb	45Kg / 99lb
VS8DW110FG45	VS8DW110BG45	45	3.6kW / 4.9hp	65	515Nm / 380lb-ft	295Nm / 217lb-ft	40Kg / 88lb	45Kg / 99lb
VS8DW110FG64	VS8DW110BG64	64	3.3kW / 4.5hp	47	690Nm / 508lb-ft	365Nm / 269lb-ft	40Kg / 88lb	45Kg / 99lb

GLOBE V10 + worm gear

VS10DW85FG7	VS10DW85BG7	7	7.2kW / 9.8hp	340	210Nm / 155lb-ft	150Nm / 111lb-ft	39Kg / 85.8lb	41Kg / 90.2lb
VS10DW110FG16	VS10DW110BG16	16	7kW / 9.5hp	150	460Nm / 339lb-ft	290Nm / 214lb-ft	55Kg / 121lb	60Kg / 132lb
VS10DW110FG23	VS10DW110BG23	23	6.9kW / 9.4hp	105	650Nm / 479lb-ft	405Nm / 298lb-ft	55Kg / 121lb	60Kg / 132lb

* Power and nominal torque at 6 bar and motor input speed of 3000 rpm (V4, V6, V8) and 2400 rpm (V10).

** In applications where the motor input speed exceeds 2200 rpm, only intermittent use is tolerated.



DIMENSIONS GLOBE VANE AIR MOTORS WORM GEARBOX - FLANGE MODEL

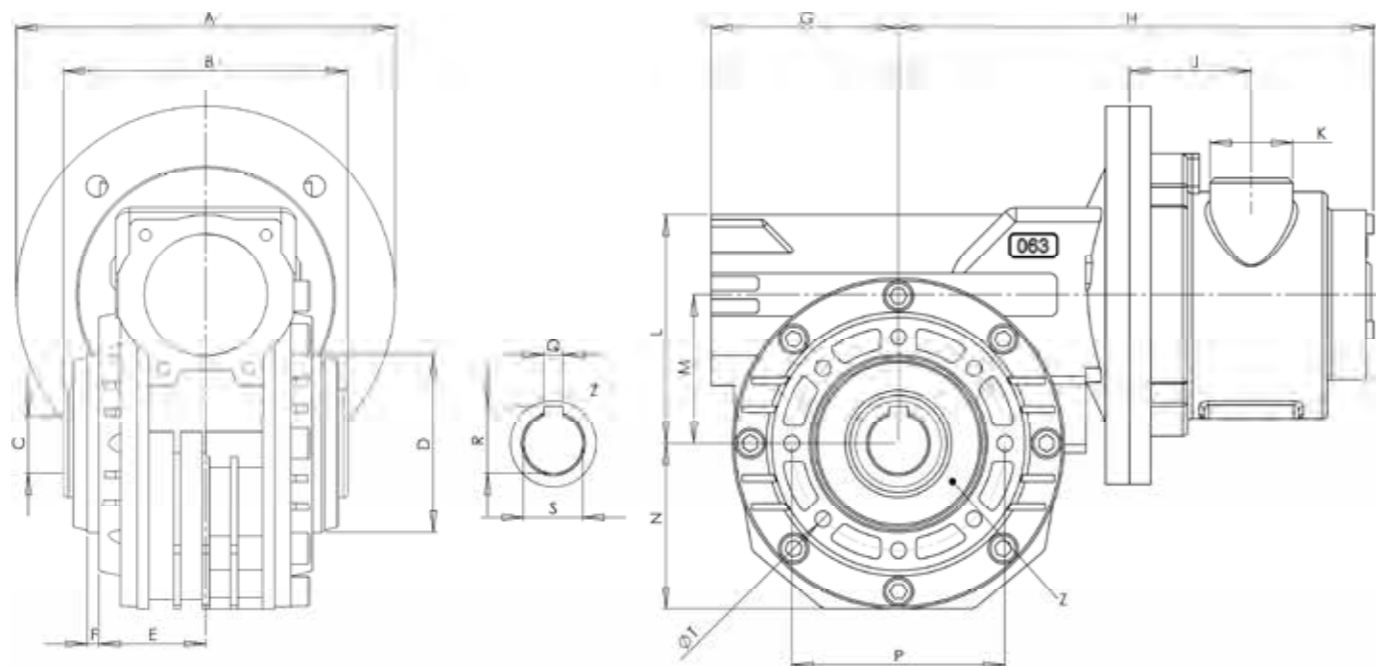

Ordering code	A	B	C	D	E	F	G	H	J
VS4DW63FG7	160 (6.29")	120 (4.72")	25H8 (0.98")	75h8 (2.95")	45 (1.77")	5 (0.19")	79 (3.11")	203 (7.99")	55 (2.16")
VS4DW63FG15	160 (6.29")	120 (4.72")	25H8 (0.98")	75h8 (2.95")	45 (1.77")	5 (0.19")	79 (3.11")	203 (7.99")	55 (2.16")
VS4DW63FG30	160 (6.29")	120 (4.72")	25H8 (0.98")	75h8 (2.95")	45 (1.77")	5 (0.19")	79 (3.11")	203 (7.99")	55 (2.16")
VS4DW63FG45	160 (6.29")	120 (4.72")	25H8 (0.98")	75h8 (2.95")	45 (1.77")	5 (0.19")	79 (3.11")	203 (7.99")	55 (2.16")
VS4DW85FG67	160 (6.29")	135 (5.31")	35H8 (1.37")	110h8 (4.33")	64 (2.52")	3.5 (0.14")	98 (3.86")	227 (8.94")	55 (2.16")
VS4DW85FG74	160 (6.29")	135 (5.31")	35H8 (1.37")	110h8 (4.33")	64 (2.52")	3.5 (0.14")	98 (3.86")	227 (8.94")	55 (2.16")
VS6DW63FG7	200 (7.87")	120 (4.72")	25H8 (0.98")	75h8 (2.95")	45 (1.77")	5 (0.19")	79 (3.11")	252 (9.92")	78 (3.07")
VS6DW63FG15	200 (7.87")	120 (4.72")	25H8 (0.98")	75h8 (2.95")	45 (1.77")	5 (0.19")	79 (3.11")	252 (9.92")	78 (3.07")
VS6DW85FG28	200 (7.87")	135 (5.31")	35H8 (1.37")	110h8 (4.33")	64 (2.52")	3.5 (0.14")	98 (3.86")	276 (10.86")	78 (3.07")
VS6DW85FG46	200 (7.87")	135 (5.31")	35H8 (1.37")	110h8 (4.33")	64 (2.52")	3.5 (0.14")	98 (3.86")	276 (10.86")	78 (3.07")
VS6DW110FG64	200 (7.87")	155 (6.10")	42H8 (1.65")	130h8 (5.12")	74 (2.91")	3.5 (0.14")	118 (4.64")	296 (11.65")	78 (3.07")
VS6DW110FG84	200 (7.87")	155 (6.10")	42H8 (1.65")	130h8 (5.12")	74 (2.91")	3.5 (0.14")	118 (4.64")	296 (11.65")	78 (3.07")
VS8DW85FG7	200 (7.87")	135 (5.31")	35H8 (1.37")	110h8 (4.33")	64 (2.52")	3.5 (0.14")	98 (3.86")	279 (10.98")	84 (3.31")
VS8DW85FG14	200 (7.87")	135 (5.31")	35H8 (1.37")	110h8 (4.33")	64 (2.52")	3.5 (0.14")	98 (3.86")	279 (10.98")	84 (3.31")
VS8DW110FG30	200 (7.87")	155 (6.10")	42H8 (1.65")	130h8 (5.12")	74 (2.91")	3.5 (0.14")	118 (4.64")	299 (11.77")	84 (3.31")
VS8DW110FG45	200 (7.87")	155 (6.10")	42H8 (1.65")	130h8 (5.12")	74 (2.91")	3.5 (0.14")	118 (4.64")	299 (11.77")	84 (3.31")
VS8DW110FG64	200 (7.87")	155 (6.10")	42H8 (1.65")	130h8 (5.12")	74 (2.91")	3.5 (0.14")	118 (4.64")	299 (11.77")	84 (3.31")
VS10DW85FG7	250 (9.84")	135 (5.31")	35H8 (1.37")	110h8 (4.33")	64 (2.52")	3.5 (0.14")	98 (3.86")	349 (13.74")	126 (4.96")
VS10DW110FG16	250 (9.84")	155 (6.10")	42H8 (1.65")	130h8 (5.12")	74 (2.91")	3.5 (0.14")	118 (4.64")	369 (14.53")	126 (4.96")
VS10DW110FG23	250 (9.84")	155 (6.10")	42H8 (1.65")	130h8 (5.12")	74 (2.91")	3.5 (0.14")	118 (4.64")	369 (14.53")	126 (4.96")

Ordering code	K	L	M	N	P	Q	R	S	T
VS4DW63FG7	G1/2"	100 (3.94")	63 (2.48")	70 (2.75")	90 (3.54")	8 (0.31")	28.3 (1.11")	25H8 (0.98")	8xM8x17 (0.31"xM8x0.67")
VS4DW63FG15	G1/2"	100 (3.94")	63 (2.48")	70 (2.75")	90 (3.54")	8 (0.31")	28.3 (1.11")	25H8 (0.98")	8xM8x17 (0.31"xM8x0.67")
VS4DW63FG30	G1/2"	100 (3.94")	63 (2.48")	70 (2.75")	90 (3.54")	8 (0.31")	28.3 (1.11")	25H8 (0.98")	8xM8x17 (0.31"xM8x0.67")
VS4DW63FG45	G1/2"	100 (3.94")	63 (2.48")	70 (2.75")	90 (3.54")	8 (0.31")	28.3 (1.11")	25H8 (0.98")	8xM8x17 (0.31"xM8x0.67")
VS4DW85FG67	G1/2"	138 (5.43")	85 (3.34")	94.5 (3.72")	130 (5.12")	10 (0.39")	38.3 (1.51")	35H8 (1.37")	4xM10x18 (0.16"xM10x0.71")
VS4DW85FG74	G1/2"	138 (5.43")	85 (3.34")	94.5 (3.72")	130 (5.12")	10 (0.39")	38.3 (1.51")	35H8 (1.37")	4xM10x18 (0.16"xM10x0.71")
VS6DW63FG7	G3/4"	100 (3.94")	63 (2.48")	70 (2.75")	90 (3.54")	8 (0.31")	28.3 (1.11")	25H8 (0.98")	8xM8x17 (0.31"xM8x0.67")
VS6DW63FG15	G3/4"	100 (3.94")	63 (2.48")	70 (2.75")	90 (3.54")	8 (0.31")	28.3 (1.11")	25H8 (0.98")	8xM8x17 (0.31"xM8x0.67")
VS6DW85FG28	G3/4"	138 (5.43")	85 (3.34")	94.5 (3.72")	130 (5.12")	10 (0.39")	38.3 (1.51")	35H8 (1.37")	4xM10x18 (0.16"xM10x0.71")
VS6DW85FG46	G3/4"	138 (5.43")	85 (3.34")	94.5 (3.72")	130 (5.12")	10 (0.39")	38.3 (1.51")	35H8 (1.37")	4xM10x18 (0.16"xM10x0.71")
VS6DW110FG64	G3/4"	163 (6.42")	110 (4.33")	116 (4.56")	165 (6.49")	12 (0.47")	45.3 (1.78")	42H8 (1.65")	8xM12x30 (0.31"xM12x1.18")
VS6DW110FG84	G3/4"	163 (6.42")	110 (4.33")	116 (4.56")	165 (6.49")	12 (0.47")	45.3 (1.78")	42H8 (1.65")	8xM12x30 (0.31"xM12x1.18")
VS8DW85FG7	G1"	138 (5.43")	85 (3.34")	94.5 (3.72")	130 (5.12")	10 (0.39")	38.3 (1.51")	35H8 (1.37")	4xM10x18 (0.16"xM10x0.71")
VS8DW85FG14	G1"	138 (5.43")	85 (3.34")	94.5 (3.72")	130 (5.12")	10 (0.39")	38.3 (1.51")	35H8 (1.37")	4xM10x18 (0.16"xM10x0.71")
VS8DW110FG30	G1"	163 (6.42")	110 (4.33")	116 (4.56")	165 (6.49")	12 (0.47")	45.3 (1.78")	42H8 (1.65")	8xM12x30 (0.31"xM12x1.18")
VS8DW110FG45	G1"	163 (6.42")	110 (4.33")	116 (4.56")	165 (6.49")	12 (0.47")	45.3 (1.78")	42H8 (1.65")	8xM12x30 (0.31"xM12x1.18")
VS8DW110FG64	G1"	163 (6.42")	110 (4.33")	116 (4.56")	165 (6.49")	12 (0.47")	45.3 (1.78")	42H8 (1.65")	8xM12x30 (0.31"xM12x1.18")
VS10DW85FG7	G 1 1/4"	138 (5.43")	85 (3.34")	94.5 (3.72")	130 (5.12")	10 (0.39")	38.3 (1.51")	35H8 (1.37")	4xM10x18 (0.16"xM10x0.71")
VS10DW110FG16	G 1 1/4"	163 (6.42")	110 (4.33")	116 (4.56")	165 (6.49")	12 (0.47")	45.3 (1.78")	42H8 (1.65")	8xM12x30 (0.31"xM12x1.18")
VS10DW110FG23	G 1 1/4"	163 (6.42")	110 (4.33")	116 (4.56")	165 (6.49")	12 (0.47")	45.3 (1.78")	42H8 (1.65")	8xM12x30 (0.31"xM12x0.67")

DIMENSIONS GLOBE VANE AIR MOTORS WORM GEARBOX - FOOT MODEL

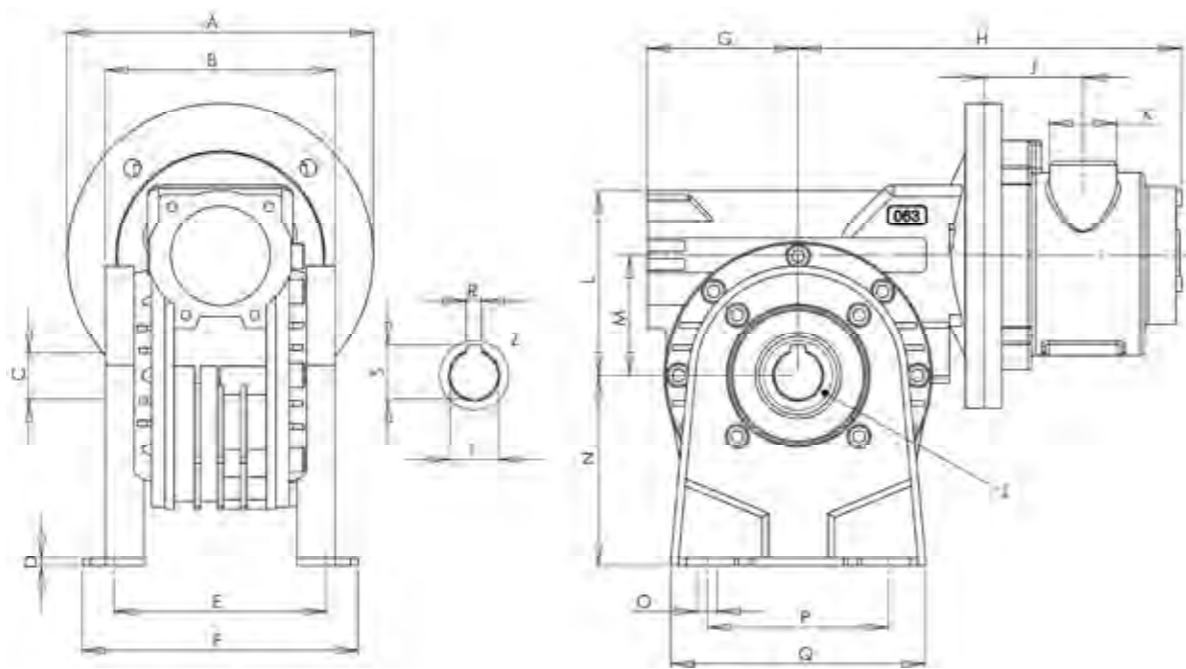

Ordering Code	A	B	C	D	E	F	G	H	J
VS4DW63BG7	160 (6.29")	120 (4.72")	25H8 (0.98")	4 (0.16")	110 (4.33")	5 (0.19")	79 (3.11")	203 (7.99")	55 (2.16")
VS4DW63BG15	160 (6.29")	120 (4.72")	25H8 (0.98")	4 (0.16")	110 (4.33")	5 (0.19")	79 (3.11")	203 (7.99")	55 (2.16")
VS4DW63BG30	160 (6.29")	120 (4.72")	25H8 (0.98")	4 (0.16")	110 (4.33")	5 (0.19")	79 (3.11")	203 (7.99")	55 (2.16")
VS4DW63BG45	160 (6.29")	120 (4.72")	25H8 (0.98")	4 (0.16")	110 (4.33")	5 (0.19")	79 (3.11")	203 (7.99")	55 (2.16")
VS4DW85BG67	160 (6.29")	135 (5.31")	35H8 (1.37")	5 (0.19")	145 (5.71")	3.5 (0.14")	98 (3.86")	227 (8.94")	55 (2.16")
VS4DW85BG74	160 (6.29")	135 (5.31")	35H8 (1.37")	5 (0.19")	145 (5.71")	3.5 (0.14")	98 (3.86")	227 (8.94")	55 (2.16")
VS6DW63BG7	200 (7.87")	120 (4.72")	25H8 (0.98")	4 (0.16")	110 (4.33")	5 (0.19")	79 (3.11")	252 (9.92")	78 (3.07")
VS6DW63BG15	200 (7.87")	120 (4.72")	25H8 (0.98")	4 (0.16")	110 (4.33")	5 (0.19")	79 (3.11")	252 (9.92")	78 (3.07")
VS6DW85BG28	200 (7.87")	135 (5.31")	35H8 (1.37")	5 (0.19")	145 (5.71")	3.5 (0.14")	98 (3.86")	276 (10.86")	78 (3.07")
VS6DW85BG46	200 (7.87")	135 (5.31")	35H8 (1.37")	5 (0.19")	145 (5.71")	3.5 (0.14")	98 (3.86")	276 (10.86")	78 (3.07")
VS6DW110BG64	200 (7.87")	155 (6.10")	42H8 (1.65")	22 (0.86")	180 (7.10")	3.5 (0.14")	118 (4.64")	296 (11.65")	78 (3.07")
VS6DW110BG84	200 (7.87")	155 (6.10")	42H8 (1.65")	22 (0.86")	180 (7.10")	3.5 (0.14")	118 (4.64")	296 (11.65")	78 (3.07")
VS8DW85BG7	200 (7.87")	135 (5.31")	35H8 (1.37")	5 (0.19")	145 (5.71")	3.5 (0.14")	98 (3.86")	279 (10.98")	84 (3.31")
VS8DW85BG14	200 (7.87")	135 (5.31")	35H8 (1.37")	5 (0.19")	145 (5.71")	3.5 (0.14")	98 (3.86")	279 (10.98")	84 (3.31")
VS8DW110BG30	200 (7.87")	155 (6.10")	42H8 (1.65")	22 (0.86")	180 (7.10")	3.5 (0.14")	118 (4.64")	299 (11.77")	84 (3.31")
VS8DW110BG45	200 (7.87")	155 (6.10")	42H8 (1.65")	22 (0.86")	180 (7.10")	3.5 (0.14")	118 (4.64")	299 (11.77")	84 (3.31")
VS8DW110BG64	200 (7.87")	155 (6.10")	42H8 (1.65")	22 (0.86")	180 (7.10")	3.5 (0.14")	118 (4.64")	299 (11.77")	84 (3.31")
VS10DW85BG7	250 (9.84")	135 (5.31")	35H8 (1.37")	5 (0.19")	145 (5.71")	3.5 (0.14")	98 (3.86")	349 (13.74")	126 (4.96")
VS10DW110BG16	250 (9.84")	155 (6.10")	42H8 (1.65")	22 (0.86")	180 (7.10")	3.5 (0.14")	118 (4.64")	369 (14.53")	126 (4.96")
VS10DW110BG23	250 (9.84")	155 (6.10")	42H8 (1.65")	22 (0.86")	180 (7.10")	3.5 (0.14")	118 (4.64")	369 (14.53")	126 (4.96")

Ordering Code	K	L	M	N	O	P	Q	R	S	T
VS4DW63FG7	G1/2"	100 (3.94")	63 (2.48")	100 (3.94")	10,5 (0.41")	95 (3.74")	133 (5.23")	8 (0.31")	28.3 (1.11")	25H8 (0.98")
VS4DW63FG15	G1/2"	100 (3.94")	63 (2.48")	100 (3.94")	10,5 (0.41")	95 (3.74")	133 (5.23")	8 (0.31")	28.3 (1.11")	25H8 (0.98")
VS4DW63FG30	G1/2"	100 (3.94")	63 (2.48")	100 (3.94")	10,5 (0.41")	95 (3.74")	133 (5.23")	8 (0.31")	28.3 (1.11")	25H8 (0.98")
VS4DW63FG45	G1/2"	100 (3.94")	63 (2.48")	100 (3.94")	10,5 (0.41")	95 (3.74")	133 (5.23")	8 (0.31")	28.3 (1.11")	25H8 (0.98")
VS4DW85FG67	G1/2"	138 (5.43")	85 (3.34")	142 (5.60")	10,5 (0.41")	140 (5.51")	180 (7.10")	10 (0.39")	38.3 (1.51")	35H8 (1.37")
VS4DW85FG74	G1/2"	138 (5.43")	85 (3.34")	142 (5.60")	10,5 (0.41")	140 (5.51")	180 (7.10")	10 (0.39")	38.3 (1.51")	35H8 (1.37")
VS6DW63FG7	G3/4"	100 (3.94")	63 (2.48")	100 (3.94")	10,5 (0.41")	95 (3.74")	133 (5.23")	8 (0.31")	28.3 (1.11")	25H8 (0.98")
VS6DW63FG15	G3/4"	100 (3.94")	63 (2.48")	100 (3.94")	10,5 (0.41")	95 (3.74")	133 (5.23")	8 (0.31")	28.3 (1.11")	25H8 (0.98")
VS6DW85FG28	G3/4"	138 (5.43")	85 (3.34")	142 (5.60")	10,5 (0.41")	140 (5.51")	180 (7.10")	10 (0.39")	38.3 (1.51")	35H8 (1.37")
VS6DW85FG46	G3/4"	138 (5.43")	85 (3.34")	142 (5.60")	10,5 (0.41")	140 (5.51")	180 (7.10")	10 (0.39")	38.3 (1.51")	35H8 (1.37")
VS6DW110FG64	G3/4"	163 (6.42")	110 (4.33")	170 (6.70")	13 (0.51")	200 (7.87")	240 (9.45")	12 (0.47")	45.3 (1.78")	42H8 (1.65")
VS6DW110FG84	G3/4"	163 (6.42")	110 (4.33")	170 (6.70")	13 (0.51")	200 (7.87")	240 (9.45")	12 (0.47")	45.3 (1.78")	42H8 (1.65")
VS8DW85FG7	G1"	138 (5.43")	85 (3.34")	142 (5.60")	10,5 (0.41")	140 (5.51")	180 (7.10")	10 (0.39")	38.3 (1.51")	35H8 (1.37")
VS8DW85FG14	G1"	138 (5.43")	85 (3.34")	142 (5.60")	10,5 (0.41")	140 (5.51")	180 (7.10")	10 (0.39")	38.3 (1.51")	35H8 (1.37")
VS8DW110FG30	G1"	163 (6.42")	110 (4.33")	170 (6.70")	13 (0.51")	200 (7.87")	240 (9.45")	12 (0.47")	45.3 (1.78")	42H8 (1.65")
VS8DW110FG45	G1"	163 (6.42")	110 (4.33")	170 (6.70")	13 (0.51")	200 (7.87")	240 (9.45")	12 (0.47")	45.3 (1.78")	42H8 (1.65")
VS8DW110FG64	G1"	163 (6.42")	110 (4.33")	170 (6.70")	13 (0.51")	200 (7.87")	240 (9.45")	12 (0.47")	45.3 (1.78")	42H8 (1.65")
VS10DW85FG7	G 1 1/4"	138 (5.43")	85 (3.34")	142 (5.60")	10,5 (0.41")	140 (5.51")	180 (7.10")	10 (0.39")	38.3 (1.51")	35H8 (1.37")
VS10DW110FG16	G 1 1/4"	163 (6.42")	110 (4.33")	170 (6.70")	13 (0.51")	200 (7.87")	240 (9.45")	12 (0.47")	45.3 (1.78")	42H8 (1.65")
VS10DW110FG23	G 1 1/4"	163 (6.42")	110 (4.33")	170 (6.70")	13 (0.51")	200 (7.87")	240 (9.45")	12 (0.47")	45.3 (1.78")	42H8 (1.65")

DIMENSIONS OUTPUT SHAFT FOR WORM GEARS (OPTIONAL)

SINGLE OUTPUT SHAFT

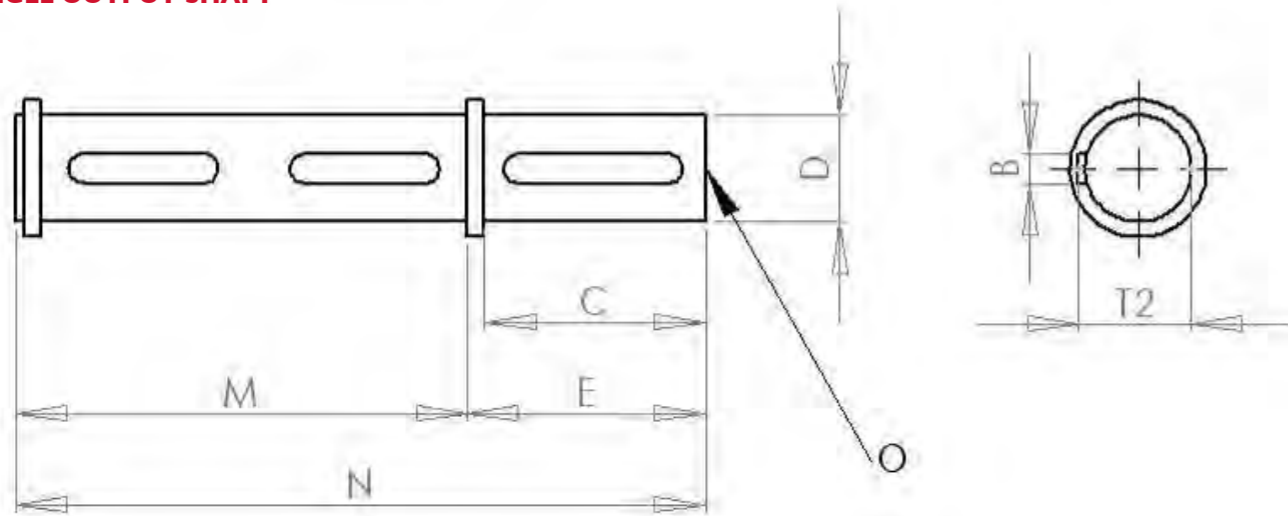

Size gearbox	B	C	D	E	M	N	O	T2
063	8 (0.31")	60 (2.36")	25 (0.98")	63 (2.48")	127 (5.00")	190 (7.48")	M8x20 (0.79")	28.3 (1.11")
085	10 (0.39")	60 (2.36")	35 (1.38")	73.5 (2.89")	140 (5.51")	214 (8.42")	M10x23 (0.90")	38.3 (1.51")
110	12 (0.47")	75 (2.95")	42 (1.65")	96.5 (3.80")	163.5 (6.43")	260 (10.23")	M12x32 (1.26")	45.3 (1.78")

DOUBLE OUTPUT SHAFT

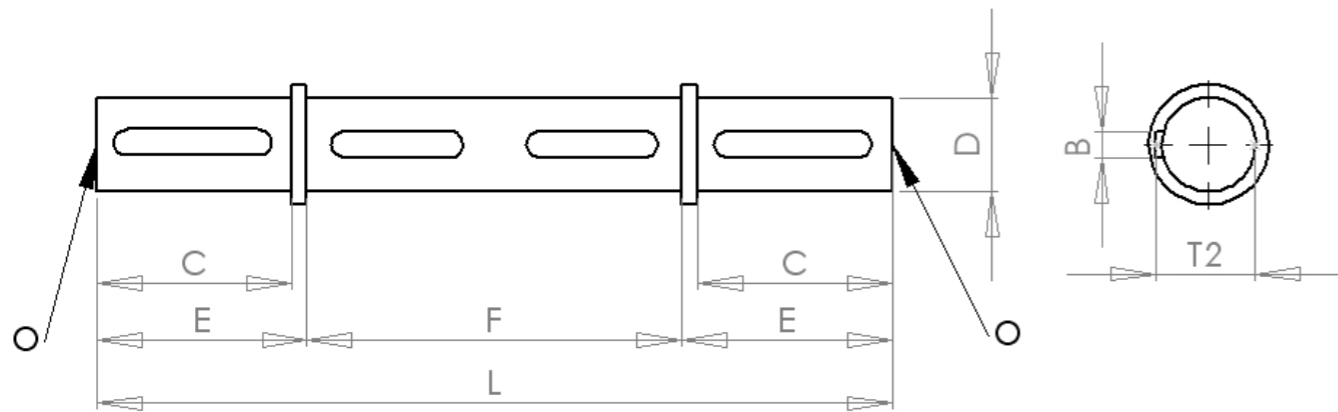

Size gearbox	B	C	D	E	F	L	O	T2
063	8 (0.31")	60 (2.36")	25 (0.98")	63 (2.48")	120 (4.72")	246,4 (9.70")	M8x20 (0.79")	28.3 (1.11")
085	10 (0.39")	60 (2.36")	35 (1.38")	73.5 (2.89")	135 (5.31")	282 (11.10")	M10x23 (0.90")	38.3 (1.51")
110	12 (0.47")	75 (2.95")	42 (1.65")	96.5 (3.80")	155 (6.10")	348 (13.70")	M12x32 (1.26")	45.3 (1.78")

PERFORMANCES GLOBE VS4C AIR MOTOR WORM GEARBOX

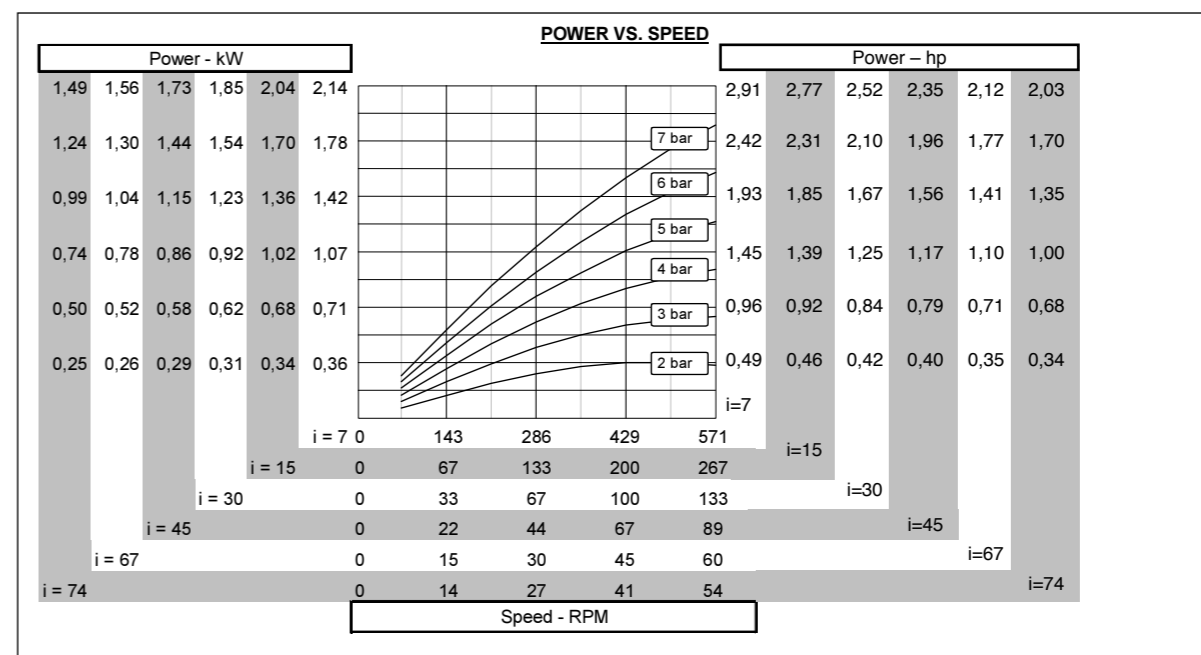
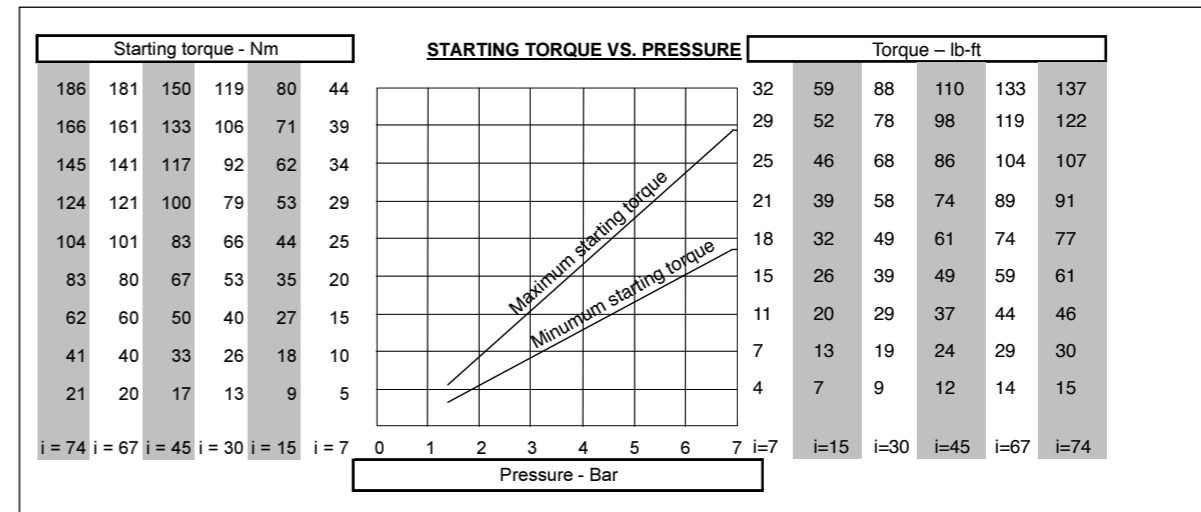
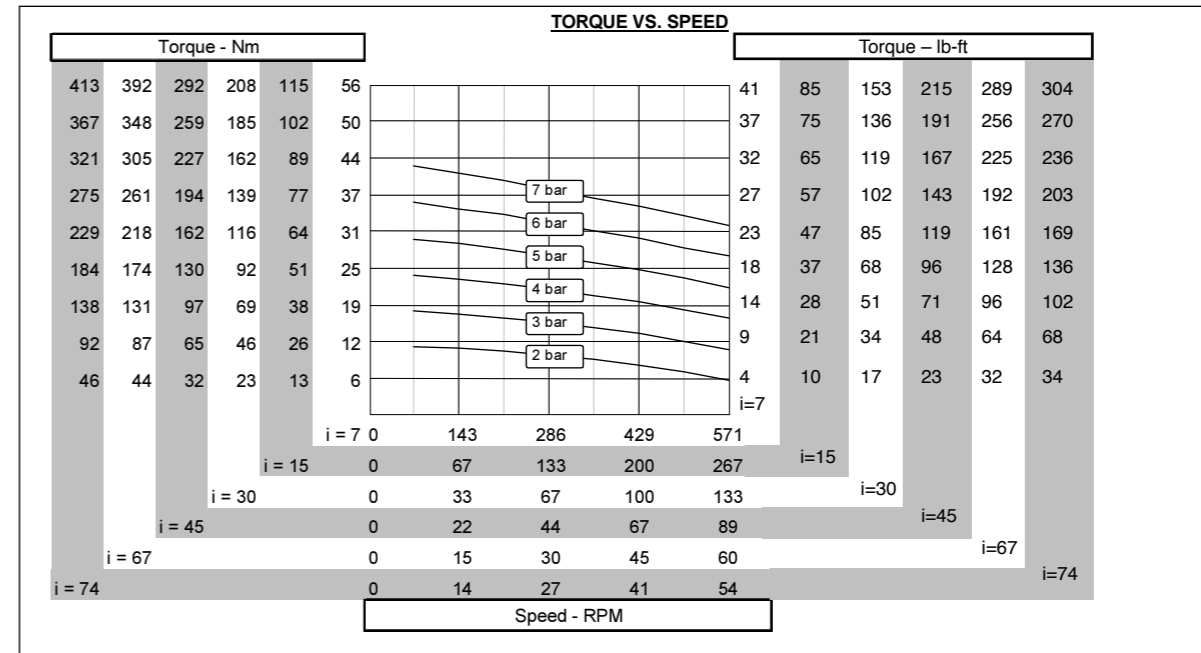

PERFORMANCES GLOBE VS6C AIR MOTOR WORM GEARBOX

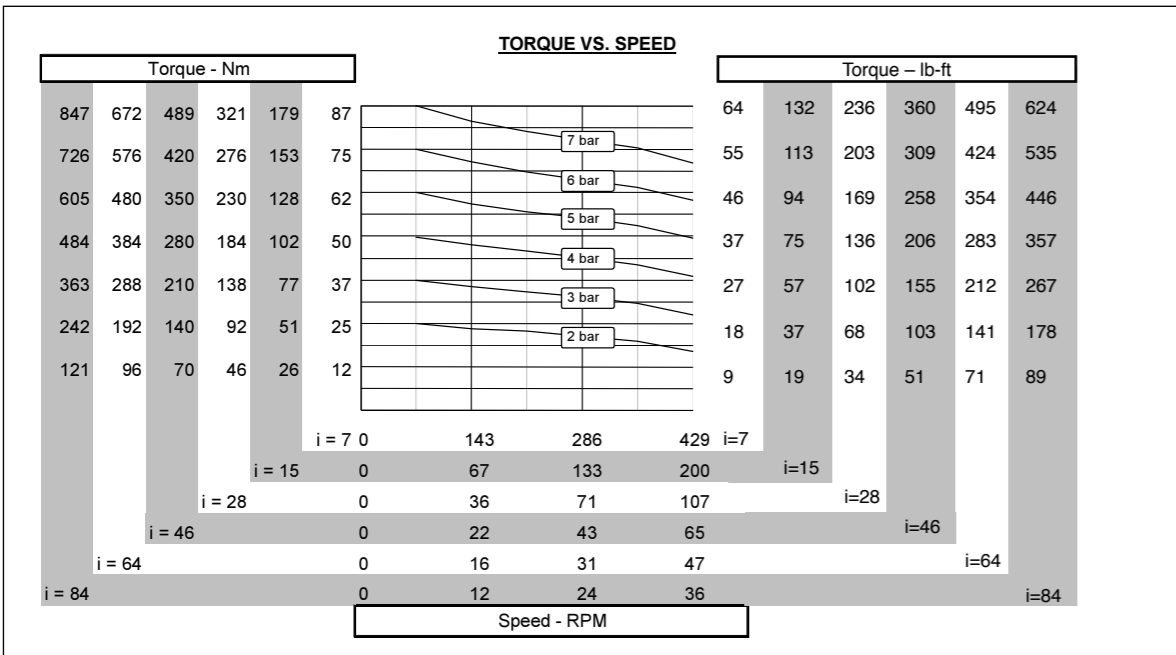

PERFORMANCES GLOBE VS8C AIR MOTOR WORM GEARBOX

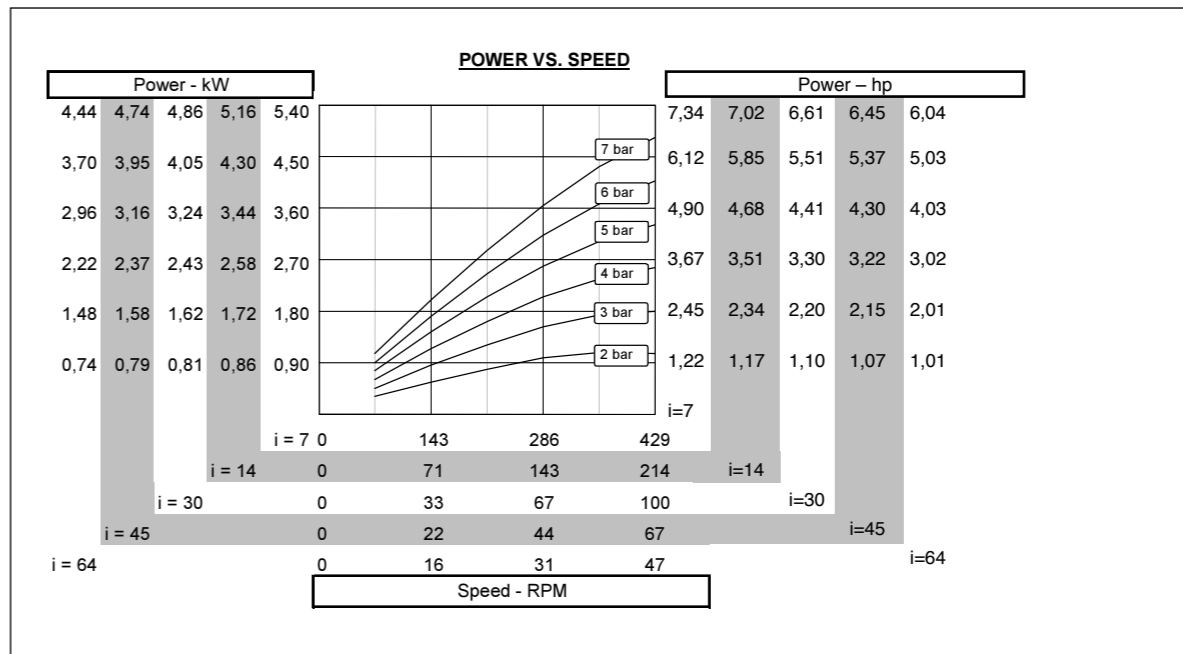
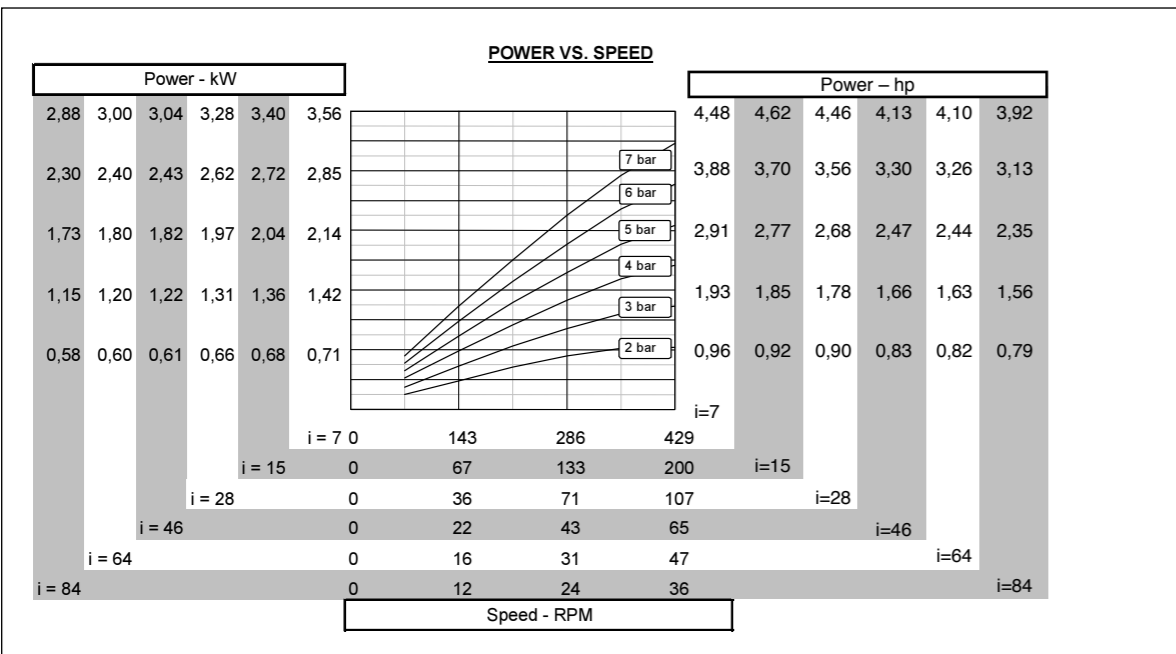
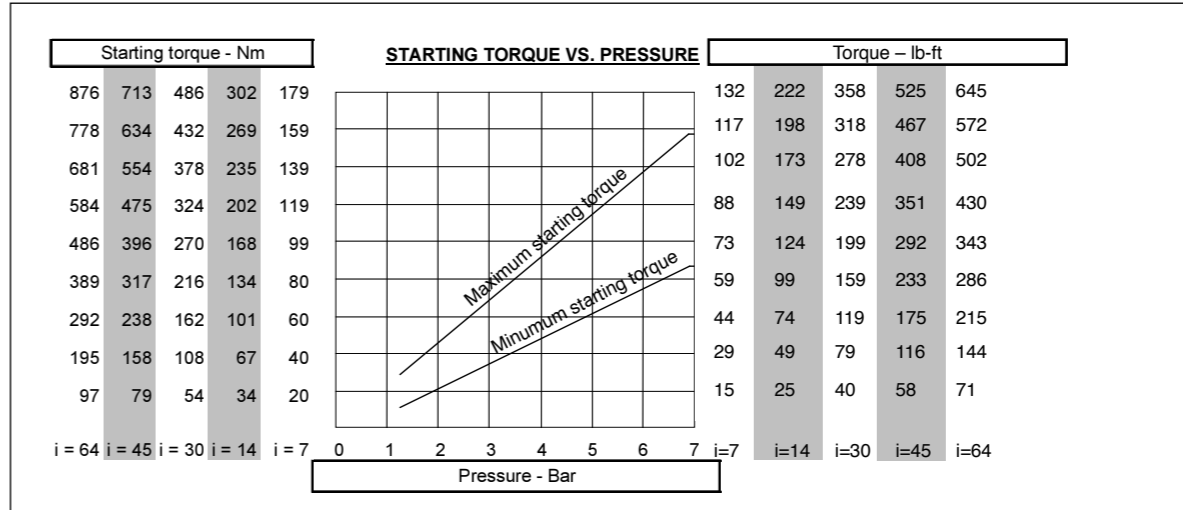
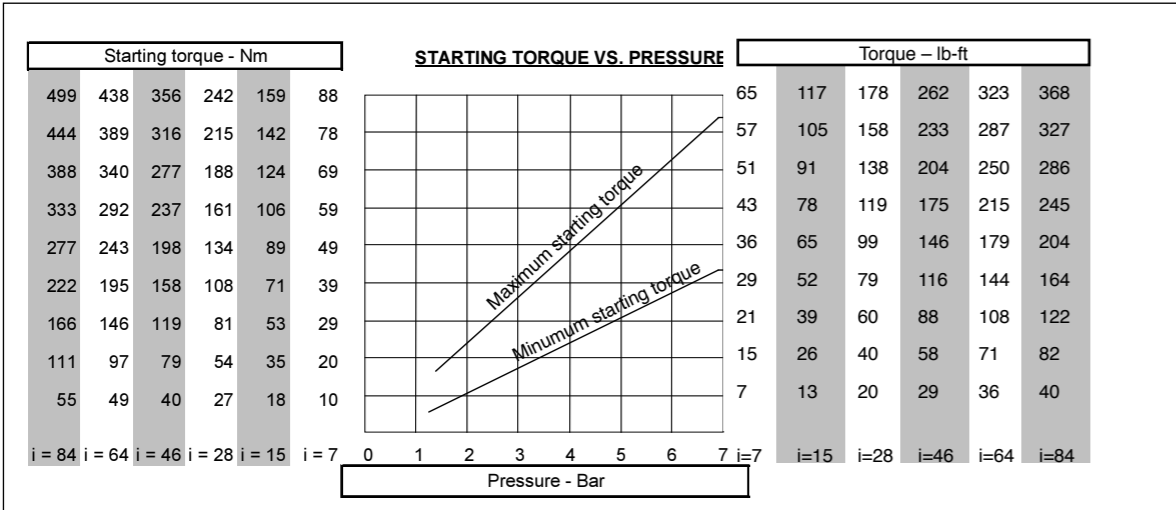
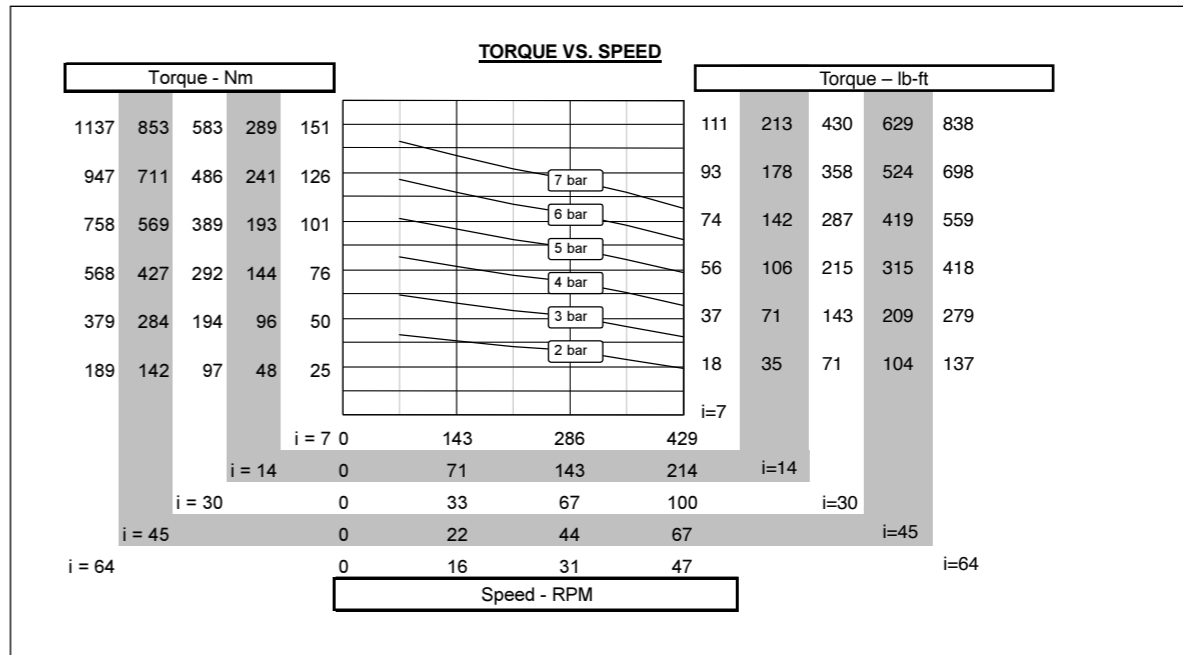

PERFORMANCES GLOBE VS10C AIR MOTOR WORM GEARBOX

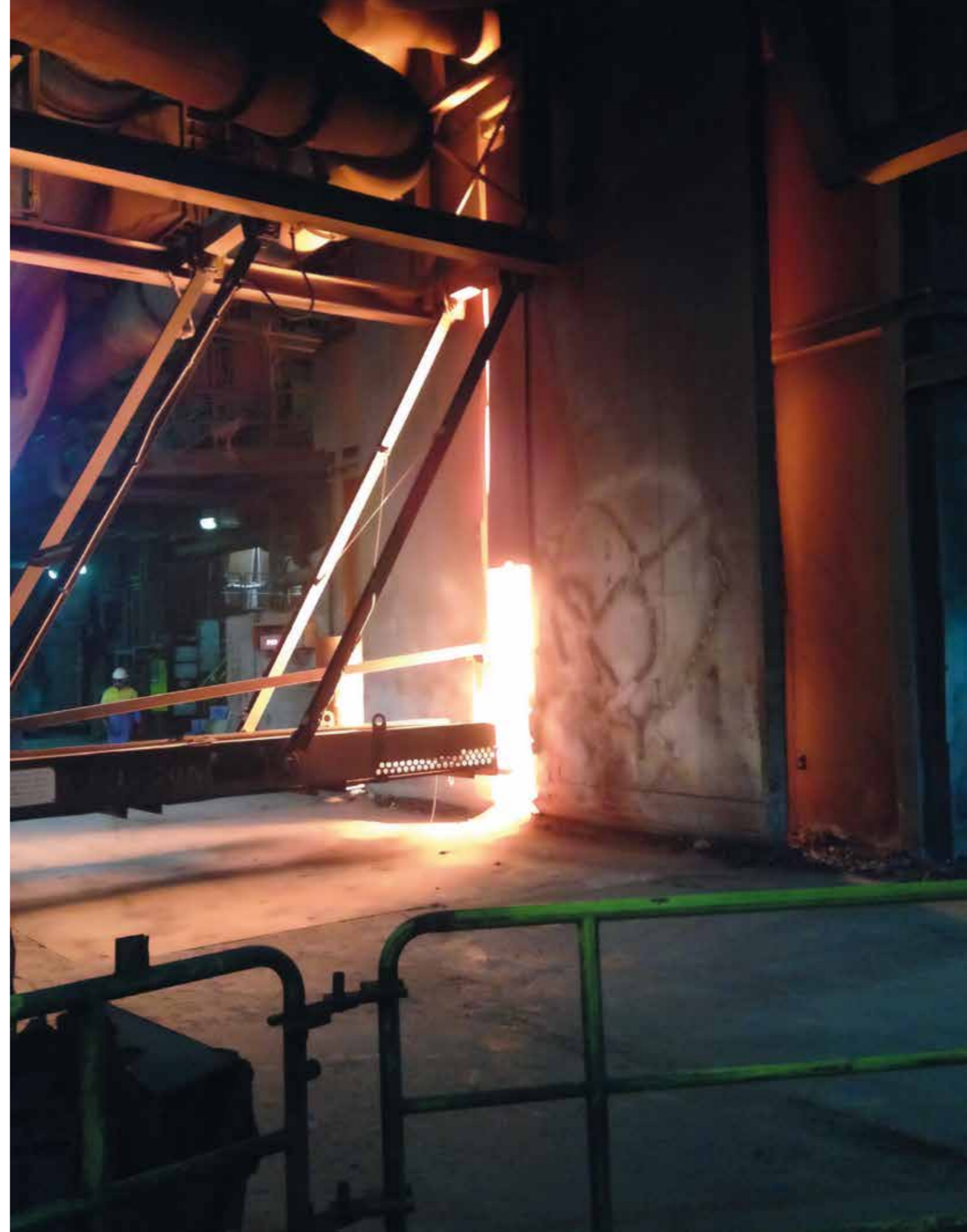
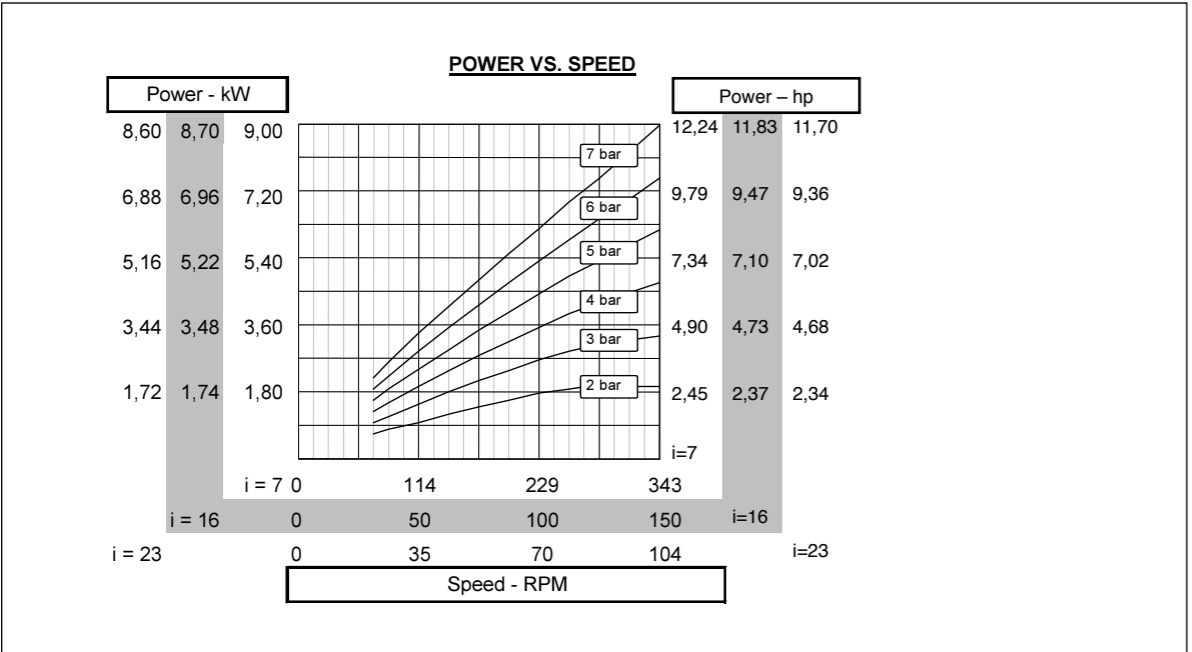
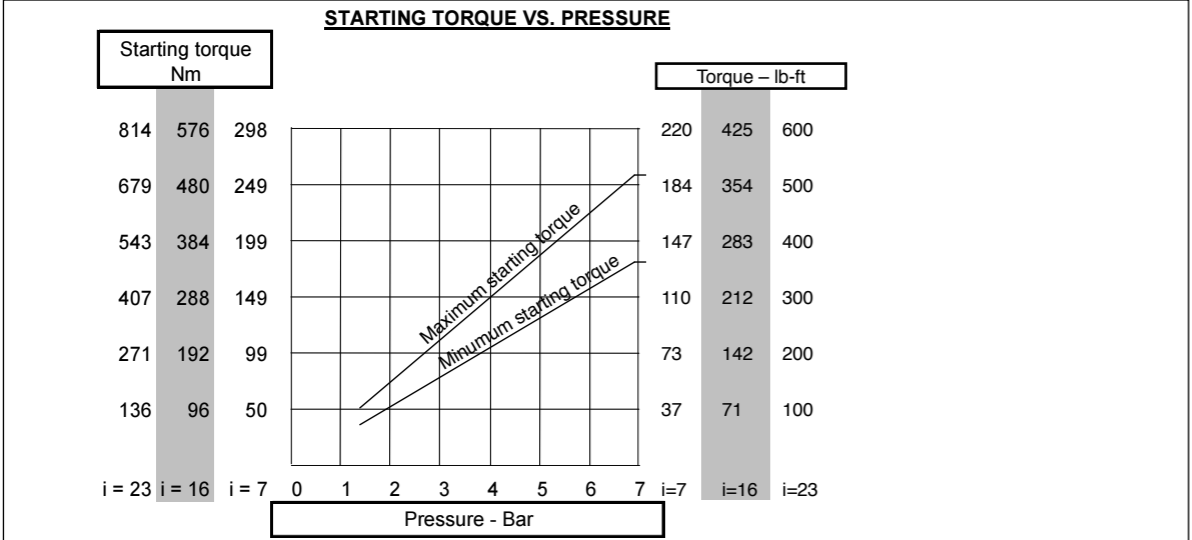
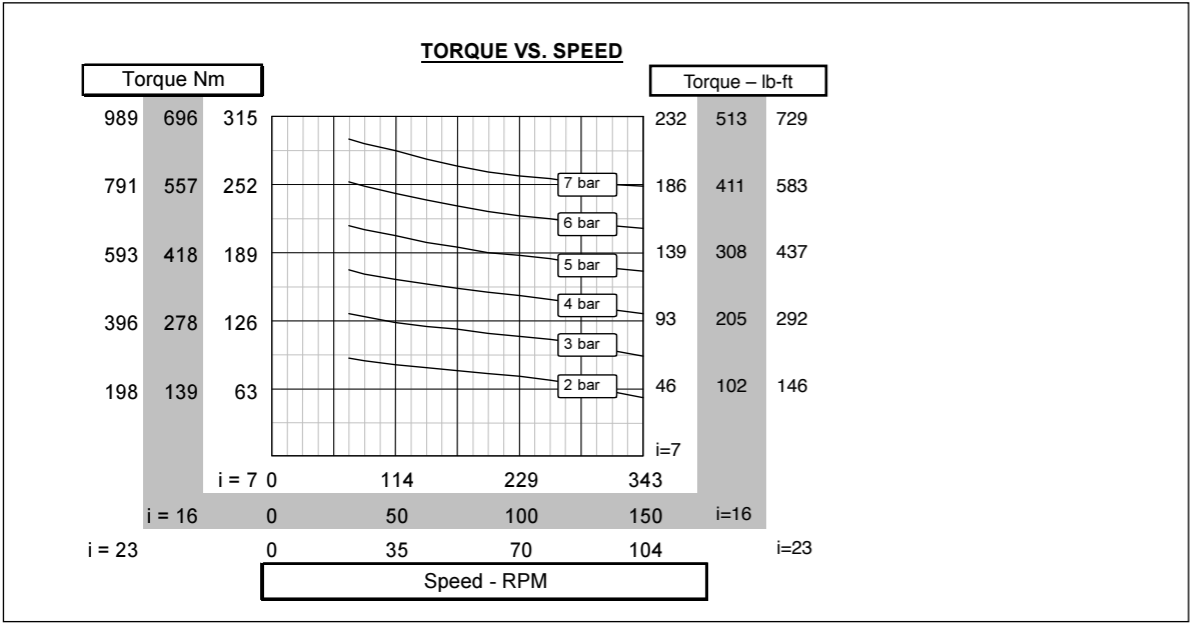

PERFORMANCE GLOBE VANE AIR MOTORS WITH COAXIAL GEARS

Ordering code flange model	Ordering code foot model	i	Power* (kW / hp)	Max. rpm**	Nominal torque (Nm / lb-ft)	Min. starting torque (Nm / lb-ft)	Weight flange model (Kg / lb)	Weight foot model (Kg / lb)
GLOBE V4 + coaxial gear								
VS4DA402FG10	VS4DA402BG10	10	1.5kW / 2.0hp	300	48Nm / 35lb-ft	42Nm / 31lb-ft	15Kg / 33lb	15Kg / 33lb
VS4DA402FG22	VS4DA402BG22	22	1.5kW / 2.0hp	136	106Nm / 78lb-ft	92Nm / 68lb-ft	15Kg / 33lb	15Kg / 33lb
VS4DC402FG29	VS4DA402BG29	29	1.5kW / 2.0hp	103	139Nm / 102lb-ft	122Nm / 90lb-ft	15Kg / 33lb	15Kg / 33lb
VS4DC402FG38	VS4DA402BG38	38	1.5kW / 2.0hp	79	182Nm / 134lb-ft	160Nm / 118lb-ft	15Kg / 33lb	15Kg / 33lb
VS4DC403FG51	VS4DA403BG51	51	1.5kW / 2.0hp	59	245Nm / 181lb-ft	214Nm / 158lb-ft	15Kg / 33lb	15Kg / 33lb
GLOBE V6 + coaxial gear								
VS6DA402FG10	VS6DA402BG10	10	2.9kW / 3.9hp	300	92Nm / 68lb-ft	75Nm / 55lb-ft	21Kg / 46lb	21Kg / 46lb
VS6DA402FG22	VS6DA402BG22	22	2.9kW / 3.9hp	136	202Nm / 149lb-ft	165Nm / 122lb-ft	21Kg / 46lb	21Kg / 46lb
VS6DA602FG29	VS6DA602BG29	29	2.9kW / 3.9hp	103	267Nm / 197lb-ft	218Nm / 161lb-ft	34Kg / 75lb	33Kg / 72,6lb
VS6DA602FG40	VS6DA602BG40	40	2.9kW / 3.9hp	75	368Nm / 271lb-ft	300Nm / 221lb-ft	34Kg / 75lb	33Kg / 72,6lb
VS6DA603FG55	VS6DA603BG55	55	2.9kW / 3.9hp	60	460Nm / 339lb-ft	375Nm / 276lb-ft	50Kg / 110lb	48Kg / 105,6lb
GLOBE V8 + coaxial gear								
VS8DA602FG10	VS8DA602BG10	10	4.5kW / 6.1hp	300	145Nm / 107lb-ft	150Nm / 111lb-ft	23Kg / 50,6lb	22Kg / 48,4lb
VS8DA602FG20	VS8DA602BG20	20	4.5kW / 6.1hp	150	290Nm / 214lb-ft	300Nm / 221lb-ft	36Kg / 79,2lb	34Kg / 74,8lb
VS8DA602FG30	VS8DA602BG30	30	4.5kW / 6.1hp	100	435Nm / 321lb-ft	450Nm / 332lb-ft	50kg / 110lb	48Kg / 105,6lb
GLOBE V8 + planetary gear								
VS8EPFG300FG42	VS8EPFG300BG42	42	4.5kW / 6.1hp	71	609Nm / 449lb-ft	630Nm / 464lb-ft	39Kg / 85,8lb	44Kg / 96,8lb
VS8EPFG300FG52	VS8EPFG300BG52	52	4.5kW / 6.1hp	55	754Nm / 556lb-ft	720Nm / 531lb-ft	39Kg / 85,8lb	44Kg / 96,8lb
GLOBE V10 + planetary gear								
VS10EPFG301FG20	VS10EPFG301BG20	20	8.3kW / 11.3hp	120	660Nm / 486lb-ft	600Nm / 442lb-ft	52Kg / 114,4lb	57Kg / 125,4lb
VS10EPFG301FG31	VS10EPFG301BG31	31	8.3kW / 11.3hp	77	1023Nm / 754lb-ft	930Nm / 685lb-ft	52Kg / 114,4lb	57Kg / 125,4lb
VS10EPFG301FG42	VS10EPFG301BG42	42	8.3kW / 11.3hp	57	1386Nm / 1021lb-ft	1260Nm / 925lb-ft	52Kg / 114,4lb	57Kg / 125,4lb
VS10EPFG301FG52	VS10EPFG301BG52	52	8.3kW / 11.3hp	46	1716Nm / 1265lb-ft	1560Nm / 1150lb-ft	52Kg / 114,4lb	57Kg / 125,4lb

* Power and nominal torque at 6 bar and motor input speed of 3000 rpm (V4, V6, V8) and 2400 rpm (V10).

** In applications where the motor input speed exceeds 2200 rpm, only intermittent use is tolerated.

DIMENSIONS GLOBE VANE AIR MOTORS WITH COAXIAL GEARS - FLANGE MODEL

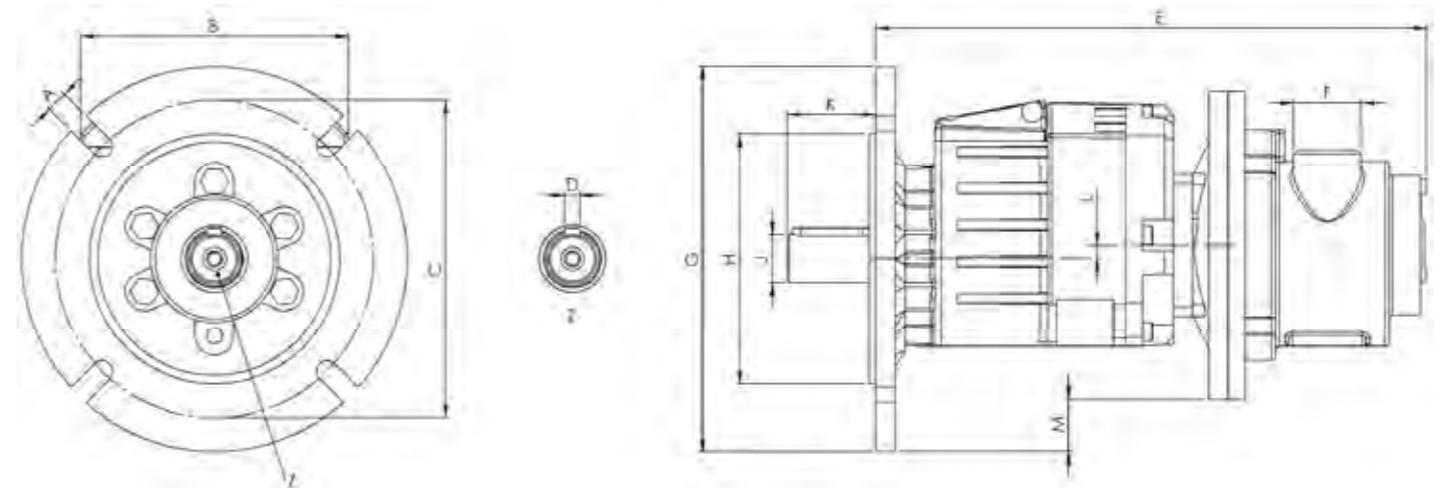

Ordering code	A	B	C	D	E	F
VS4DA402FG10	11 (0.43")	139 (5.47")	Ø165 (6.49")	8 (0.31")	283 (9.37")	G1/2"
VS4DA402FG22	11 (0.43")	139 (5.47")	Ø165 (6.49")	8 (0.31")	283 (9.37")	G1/2"
VS4DA402FG29	11 (0.43")	139 (5.47")	Ø165 (6.49")	8 (0.31")	283 (9.37")	G1/2"
VS4DA402FG38	11 (0.43")	139 (5.47")	Ø165 (6.49")	8 (0.31")	283 (9.37")	G1/2"
VS4DA403FG51	11 (0.43")	139 (5.47")	Ø165 (6.49")	8 (0.31")	288 (11.33")	G1/2"
VS6DA402FG10	Ø14 (0.55")	139 (5.47")	Ø215 (8.46")	8 (0.31")	337 (13.26")	G3/4"
VS6DA402FG22	Ø14 (0.55")	139 (5.47")	Ø215 (8.46")	8 (0.31")	337 (13.26")	G3/4"
VS6DA602FG29	Ø14 (0.55")	202 (7.95")	Ø215 (8.46")	8 (0.31")	401 (15.78")	G3/4"
VS6DA602FG40	Ø14 (0.55")	202 (7.95")	Ø215 (8.46")	8 (0.31")	401 (15.78")	G3/4"
VS6DA603FG55	Ø14 (0.55")	202 (7.95")	Ø215 (8.46")	8 (0.31")	408 (16.06")	G3/4"
VS8DA602FG10	Ø14 (0.55")	202 (7.95")	Ø164 (6.45")	8 (0.31")	404 (15.90")	G1"
VS8DA602FG20	Ø14 (0.55")	202 (7.95")	Ø164 (6.45")	8 (0.31")	404 (15.90")	G1"
VS8DA602FG30	Ø14 (0.55")	202 (7.95")	Ø164 (6.45")	8 (0.31")	404 (15.90")	G1"

Ordering code	G	H	J	K	L	M
VS4DA402FG10	Ø200 (7.87")	Ø130 (5.12")	Ø25h6 (0.98")	46 (1.81")	7 (0.27")	27 (1.06")
VS4DA402FG22	Ø200 (7.87")	Ø130 (5.12")	Ø25h6 (0.98")	46 (1.81")	7 (0.27")	27 (1.06")
VS4DA402FG29	Ø200 (7.87")	Ø130 (5.12")	Ø25h6 (0.98")	46 (1.81")	7 (0.27")	27 (1.06")
VS4DA402FG38	Ø200 (7.87")	Ø130 (5.12")	Ø25h6 (0.98")	46 (1.81")	7 (0.27")	27 (1.06")
VS4DA403FG51	Ø200 (7.87")	Ø130 (5.12")	Ø25h6 (0.98")	46 (1.81")	3 (0.12")	23 (0.90")
VS6DA402FG10	Ø250 (9.84")	Ø180 (7.08")	Ø25h6 (0.98")	46 (1.81")	7 (0.27")	32 (1.26")
VS6DA402FG22	Ø250 (9.84")	Ø180 (7.08")	Ø25h6 (0.98")	46 (1.81")	7 (0.27")	32 (1.26")
VS6DA602FG29	Ø250 (9.84")	Ø180 (7.08")	Ø30h6 (1.18")	58 (2.28")	22 (0.86")	47 (1.85")
VS6DA602FG40	Ø250 (9.84")	Ø180 (7.08")	Ø30h6 (1.18")	58 (2.28")	22 (0.86")	47 (1.85")
VS6DA603FG55	Ø250 (9.84")	Ø180 (7.08")	Ø30h6 (1.18")	58 (2.28")	16 (0.63")	41 (1.61")
VS8DA602FG10	Ø200 (7.87")	Ø128 (5.04")	Ø30h6 (1.18")	54 (2.12")	22 (0.86")	22 (0.86")
VS8DA602FG20	Ø200 (7.87")	Ø128 (5.04")	Ø30h6 (1.18")	54 (2.12")	22 (0.86")	22 (0.86")
VS8DA602FG30	Ø200 (7.87")	Ø128 (5.04")	Ø30h6 (1.18")	54 (2.12")	22 (0.86")	22 (0.86")

DIMENSIONS GLOBE VANE AIR MOTORS WITH PLANETARY GEARS - FLANGE MODEL

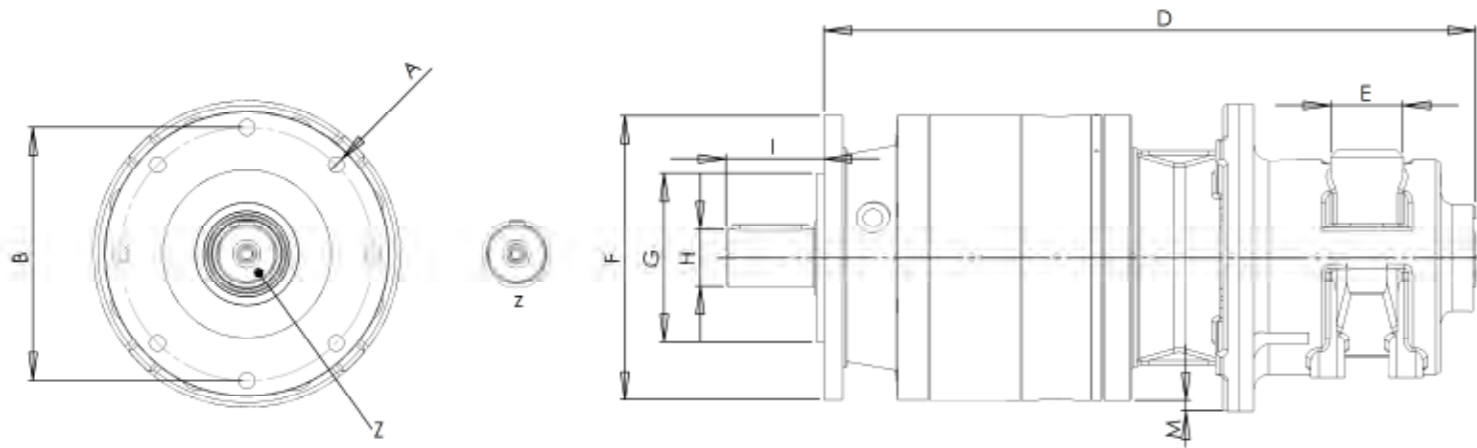

Ordering code	A	B	C	D	E	F	G	H	I
VS8EPFG300FG42	Ø10,5 (0.41")	Ø165 (6.49")	10 (0.39")	426 (16.77")	G1"	Ø185 (7.28")	Ø110 (4.33")	Ø38h6 (1.49")	64 (2.52")
VS8EPFG300FG52	Ø10,5 (0.41")	Ø165 (6.49")	10 (0.39")	426 (16.77")	G1"	Ø185 (7.28")	Ø110 (4.33")	Ø38h6 (1.49")	64 (2.52")
VS10EPFG301FG20	Ø10,5 (0.41")	Ø165 (6.49")	10 (0.39")	465 (18.30")	G1¼"	Ø250 (9.84")	Ø110 (4.33")	Ø38h6 (1.49")	64 (2.52")
VS10EPFG301FG31	Ø10,5 (0.41")	Ø165 (6.49")	10 (0.39")	465 (18.30")	G1¼"	Ø250 (9.84")	Ø110 (4.33")	Ø38h6 (1.49")	64 (2.52")
VS10EPFG301FG42	Ø10,5 (0.41")	Ø165 (6.49")	10 (0.39")	465 (18.30")	G1¼"	Ø250 (9.84")	Ø110 (4.33")	Ø38h6 (1.49")	64 (2.52")
VS10EPFG301FG52	Ø10,5 (0.41")	Ø165 (6.49")	10 (0.39")	465 (18.30")	G1¼"	Ø250 (9.84")	Ø110 (4.33")	Ø38h6 (1.49")	64 (2.52")

DIMENSIONS GLOBE VANE AIR MOTORS WITH COAXIAL GEARS - FOOT MODEL

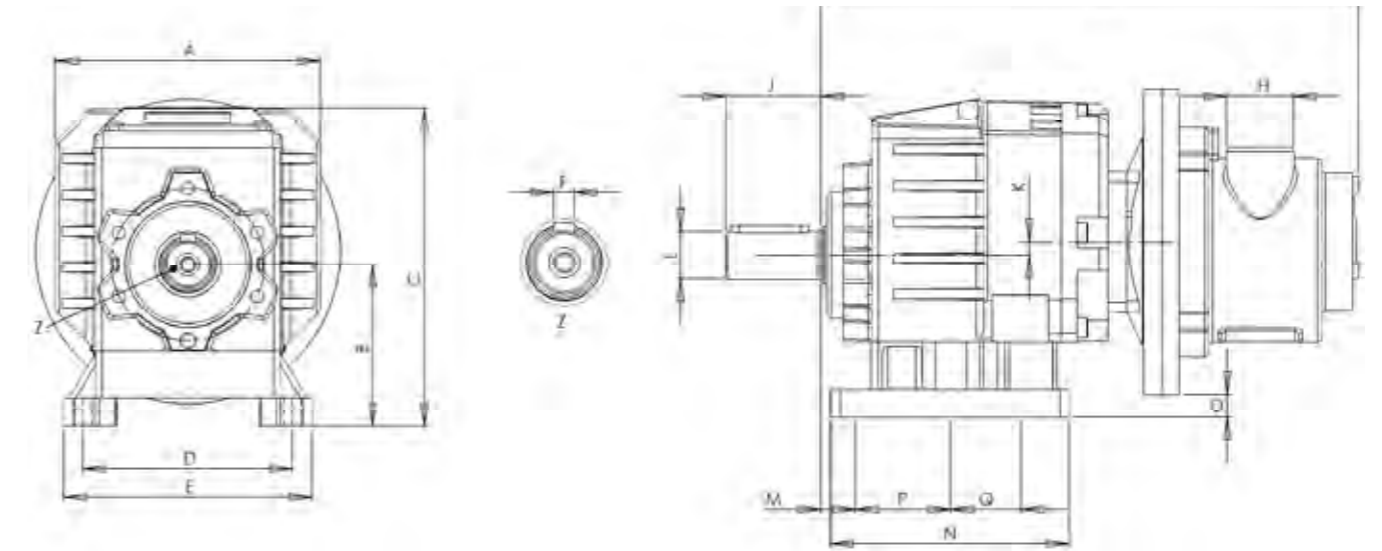

Motor + gear size	A	B	C	D	E	F	G	H
VS4DA402BG10	139 (5.47")	85 (3.34")	167 (6.57")	110 (4.33")	130 (5.12")	8 (0.31")	282 (11.10")	G1/2"
VS4DA402BG22	139 (5.47")	85 (3.34")	167 (6.57")	110 (4.33")	130 (5.12")	8 (0.31")	282 (11.10")	G1/2"
VS4DA402BG29	139 (5.47")	85 (3.34")	167 (6.57")	110 (4.33")	130 (5.12")	8 (0.31")	282 (11.10")	G1/2"
VS4DA402BG38	139 (5.47")	85 (3.34")	167 (6.57")	110 (4.33")	130 (5.12")	8 (0.31")	282 (11.10")	G1/2"
VS4DA403BG51	139 (5.47")	85 (3.34")	167 (6.57")	110 (4.33")	130 (5.12")	8 (0.31")	281 (11.06")	G1/2"
VS6DA402BG10	139 (5.47")	85 (3.34")	167 (6.57")	110 (4.33")	130 (5.12")	8 (0.31")	333 (13.11")	G3/4"
VS6DA402BG22	139 (5.47")	85 (3.34")	167 (6.57")	110 (4.33")	130 (5.12")	8 (0.31")	333 (13.11")	G3/4"
VS6DA602BG29	202 (7.95")	130 (5.12")	234 (9.21")	180 (7.08")	216 (8.50")	8 (0.31")	399 (15.71")	G3/4"
VS6DA602BG40	202 (7.95")	130 (5.12")	234 (9.21")	180 (7.08")	216 (8.50")	8 (0.31")	399 (15.71")	G3/4"
VS6DA603BG55	202 (7.95")	130 (5.12")	234 (9.21")	180 (7.08")	216 (8.50")	8 (0.31")	408 (16.06")	G3/4"
VS8DA602BG10	202 (7.95")	130 (5.12")	234 (9.21")	180 (7.08")	216 (8.50")	8 (0.31")	402 (15.83")	G1"
VS8DA602BG20	202 (7.95")	130 (5.12")	234 (9.21")	180 (7.08")	216 (8.50")	8 (0.31")	402 (15.83")	G1"
VS8DA602BG30	202 (7.95")	130 (5.12")	234 (9.21")	180 (7.08")	216 (8.50")	8 (0.31")	402 (15.83")	G1"

Motor + gear size	J	K	L	M	N	O	P	Q
VS4DA402BG10	53 (2.08")	7 (0.27")	Ø25h6 (0.98")	18 (0.71")	125 (4.92")	12 (0.47")	50 (1.97")	37 (1.45")
VS4DA402BG22	53 (2.08")	7 (0.27")	Ø25h6 (0.98")	18 (0.71")	125 (4.92")	12 (0.47")	50 (1.97")	37 (1.45")
VS4DA402BG29	53 (2.08")	7 (0.27")	Ø25h6 (0.98")	18 (0.71")	125 (4.92")	12 (0.47")	50 (1.97")	37 (1.45")
VS4DA402BG38	53 (2.08")	7 (0.27")	Ø25h6 (0.98")	18 (0.71")	125 (4.92")	12 (0.47")	50 (1.97")	37 (1.45")
VS4DA403BG51	50 (1.97")	3 (0.12")	Ø25h6 (0.98")	18 (0.71")	125 (4.92")	15 (0.59")	50 (1.97")	50 (1.97")
VS6DA402BG10	50 (1.97")	7 (0.27")	Ø25h6 (0.98")	18 (0.71")	125 (4.92")	8 (0.31")	50 (1.97")	37 (1.45")
VS6DA402BG22	50 (1.97")	7 (0.27")	Ø25h6 (0.98")	18 (0.71")	125 (4.92")	8 (0.31")	50 (1.97")	37 (1.45")
VS6DA602BG29	60 (2.36")	22 (0.86")	Ø30h6 (1.18")	20 (0.78")	186 (7.32")	52 (2.04")	150 (5.90")	...
VS6DA602BG40	60 (2.36")	22 (0.86")	Ø30h6 (1.18")	20 (0.78")	186 (7.32")	52 (2.04")	150 (5.90")	...
VS6DA603BG55	60 (2.36")	16 (0.63")	Ø30h6 (1.18")	20 (0.78")	186 (7.32")	46 (1.81")	150 (5.90")	...
VS8DA602BG10	60 (2.36")	22 (0.86")	Ø30h6 (1.18")	20 (0.78")	186 (7.32")	52 (2.04")	150 (5.90")	...
VS8DA602BG20	60 (2.36")	22 (0.86")	Ø30h6 (1.18")	20 (0.78")	186 (7.32")	52 (2.04")	150 (5.90")	...
VS8DA602BG30	60 (2.36")	22 (0.86")	Ø30h6 (1.18")	20 (0.78")	186 (7.32")	52 (2.04")	150 (5.90")	...

DIMENSIONS GLOBE VANE AIR MOTORS WITH PLANETARY GEARS - FOOT MODEL

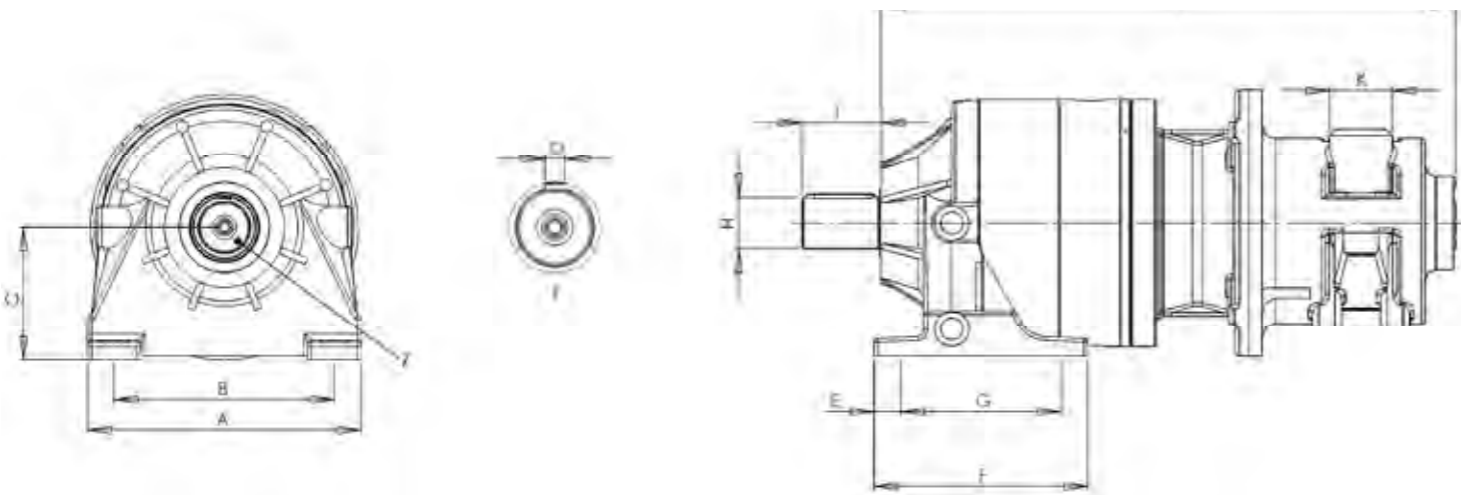

Motor + gear size	A	B	C	D	E	F	G	H	I	J	K
VS8EPFG300BG42	205 (8.07")	165 (6.49")	100 (3.93")	10 (0.39")	20	160	120	∅38h6	60	429	G1"
VS8EPFG300BG52	205 (8.07")	165 (6.49")	100 (3.93")	10 (0.39")	20	160	120	∅38h6	60	429	G1"
VS10EPFG301BG20	260 (10.23")	216 (8.50")	132 (5.19")	14 (0.55")	21	180	138	∅50h6	82	501	G1¼"
VS10EPFG301BG31	260 (10.23")	216 (8.50")	132 (5.19")	14 (0.55")	21	180	138	∅50h6	82	501	G1¼"
VS10EPFG301BG42	260 (10.23")	216 (8.50")	132 (5.19")	14 (0.55")	21	180	138	∅50h6	82	501	G1¼"
VS10EPFG301BG52	260 (10.23")	216 (8.50")	132 (5.19")	14 (0.55")	21	180	138	∅50h6	82	501	G1¼"

PERFORMANCES GLOBE VS4C AIR MOTOR WITH COAXIAL GEAR

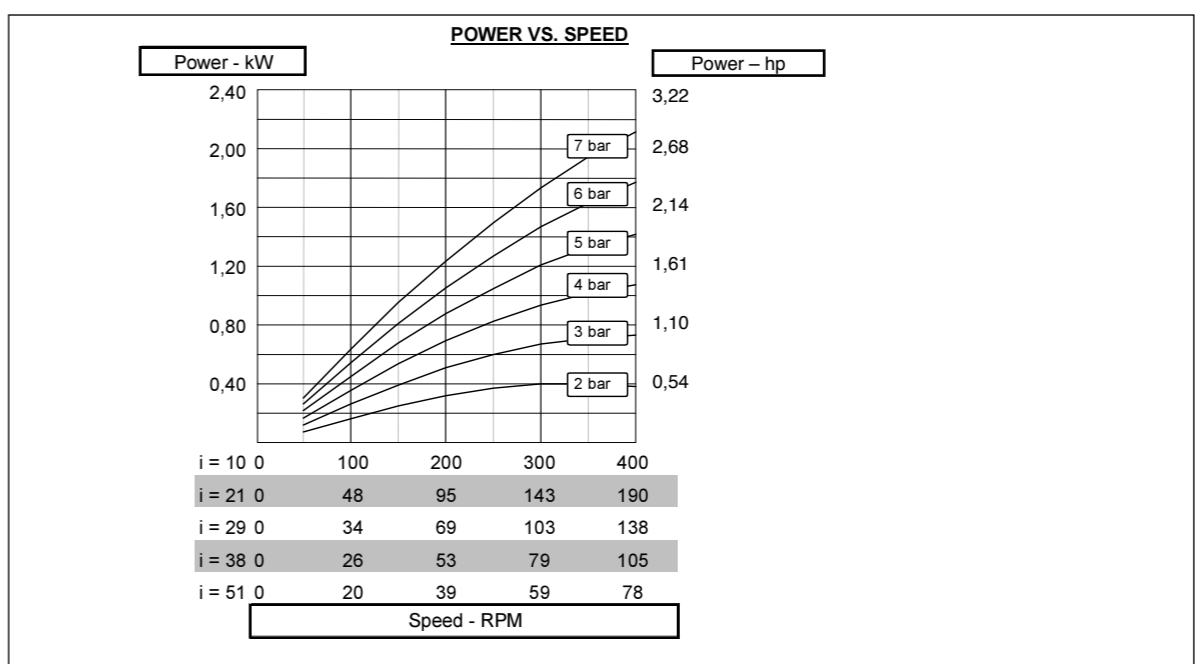
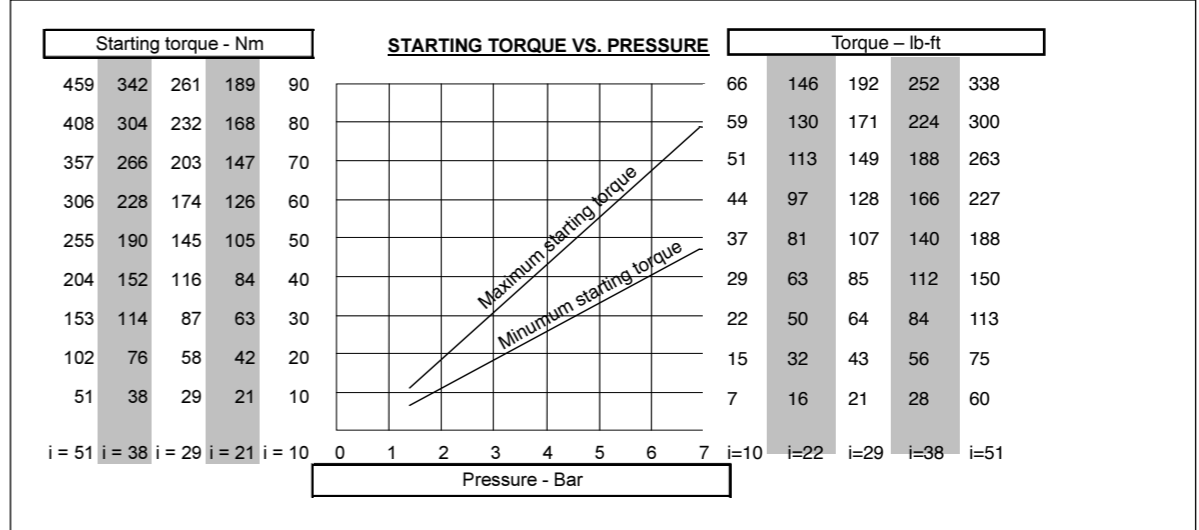
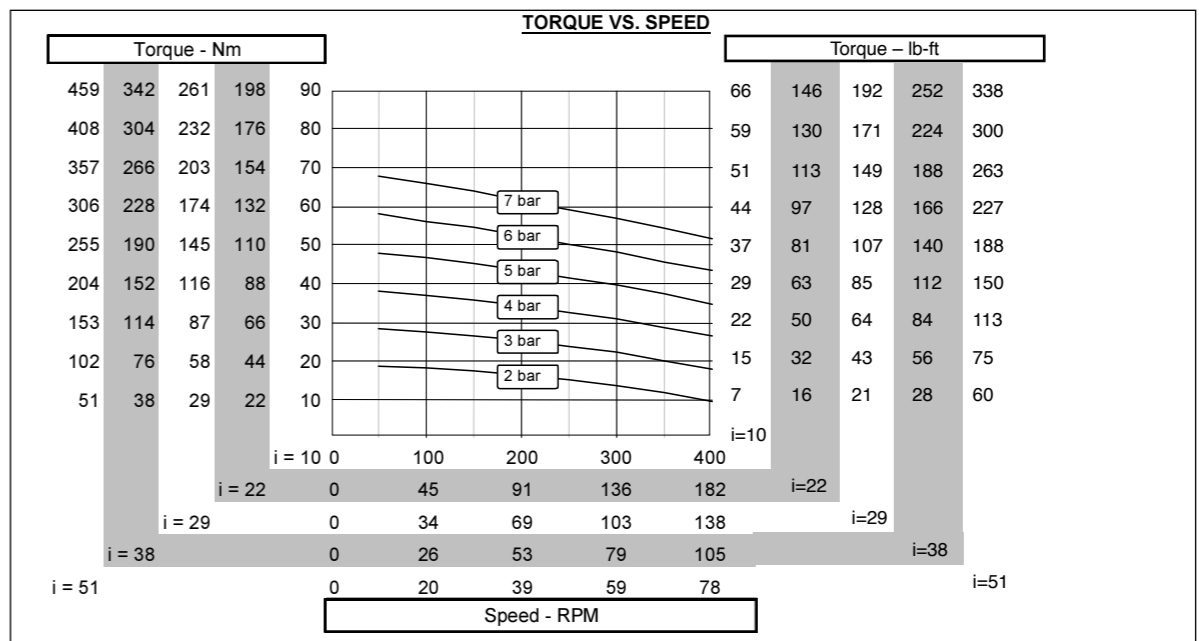

PERFORMANCES GLOBE VS6C AIR MOTOR WITH COAXIAL GEAR

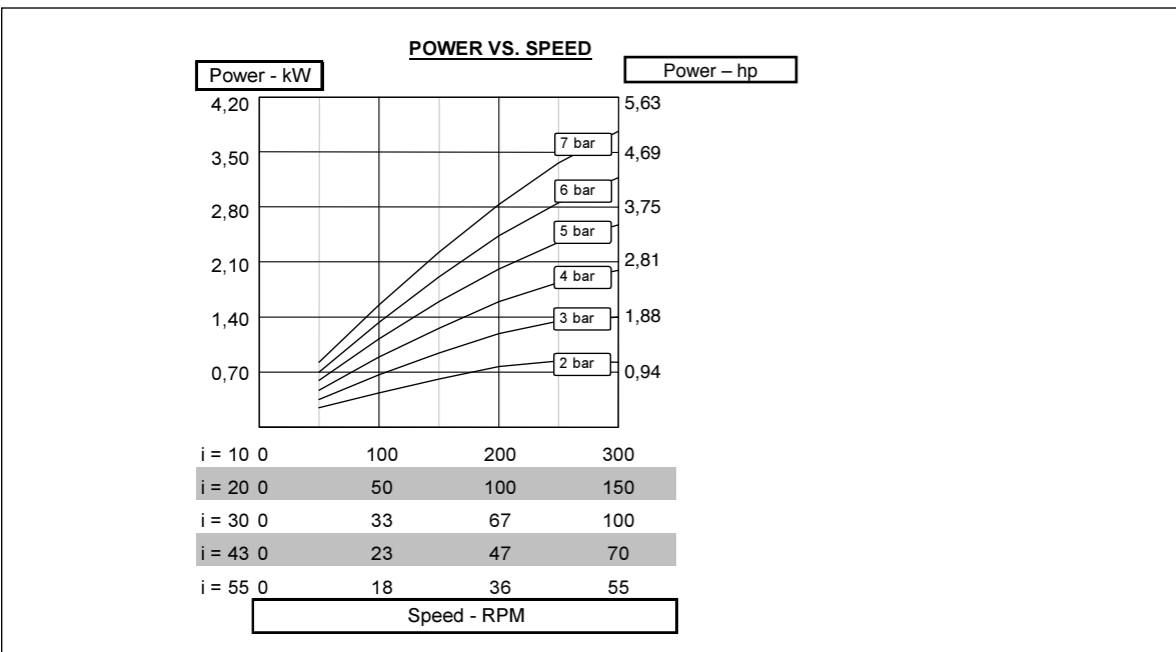
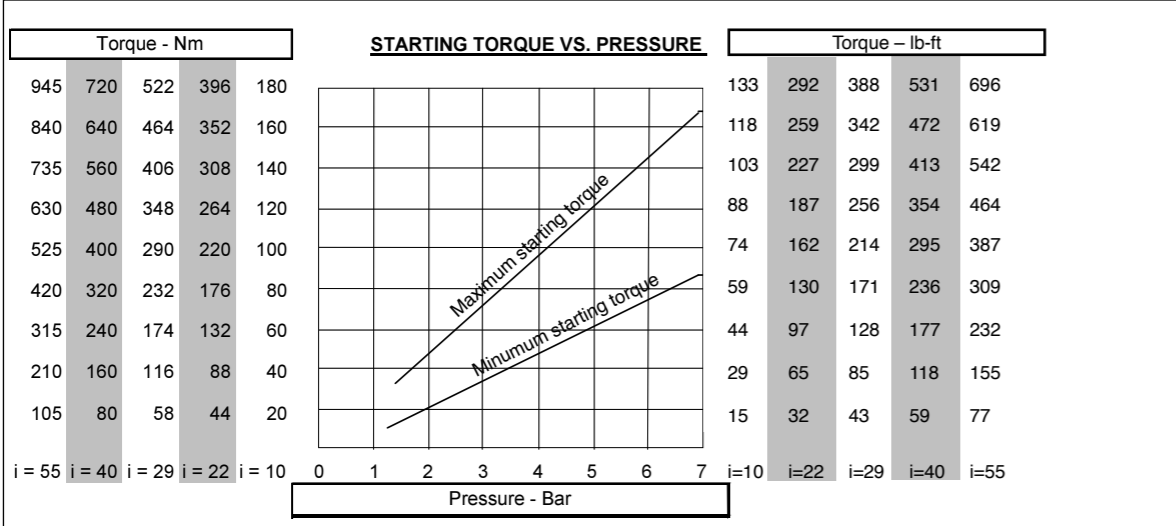
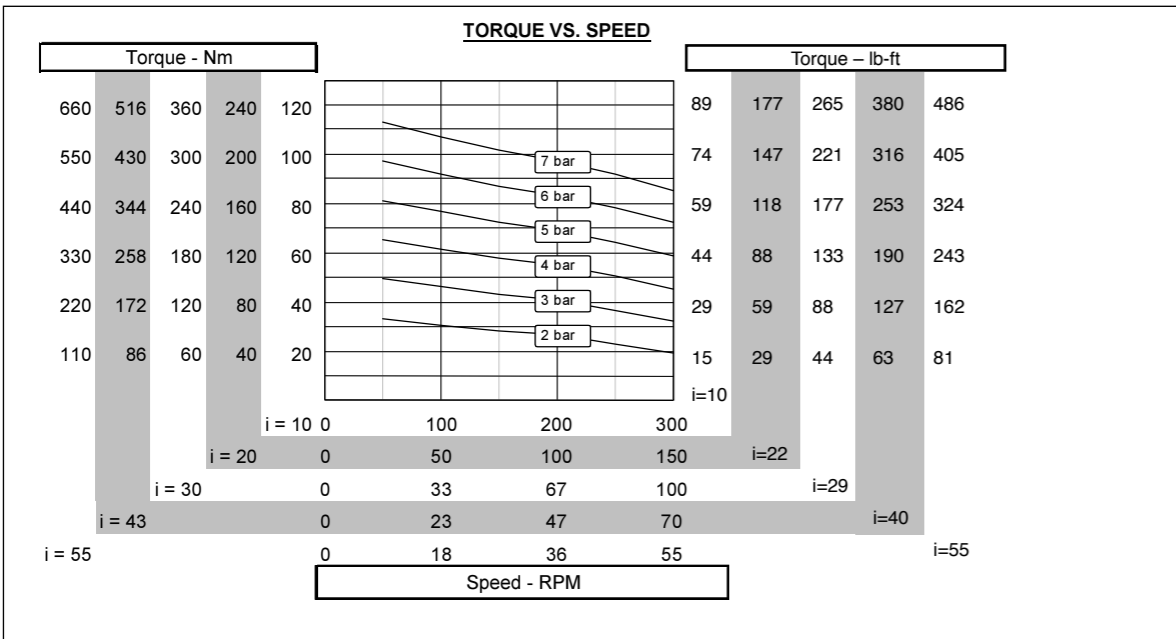

PERFORMANCES GLOBE VS8C AIR MOTOR WITH COAXIAL AND PLANETARY GEAR

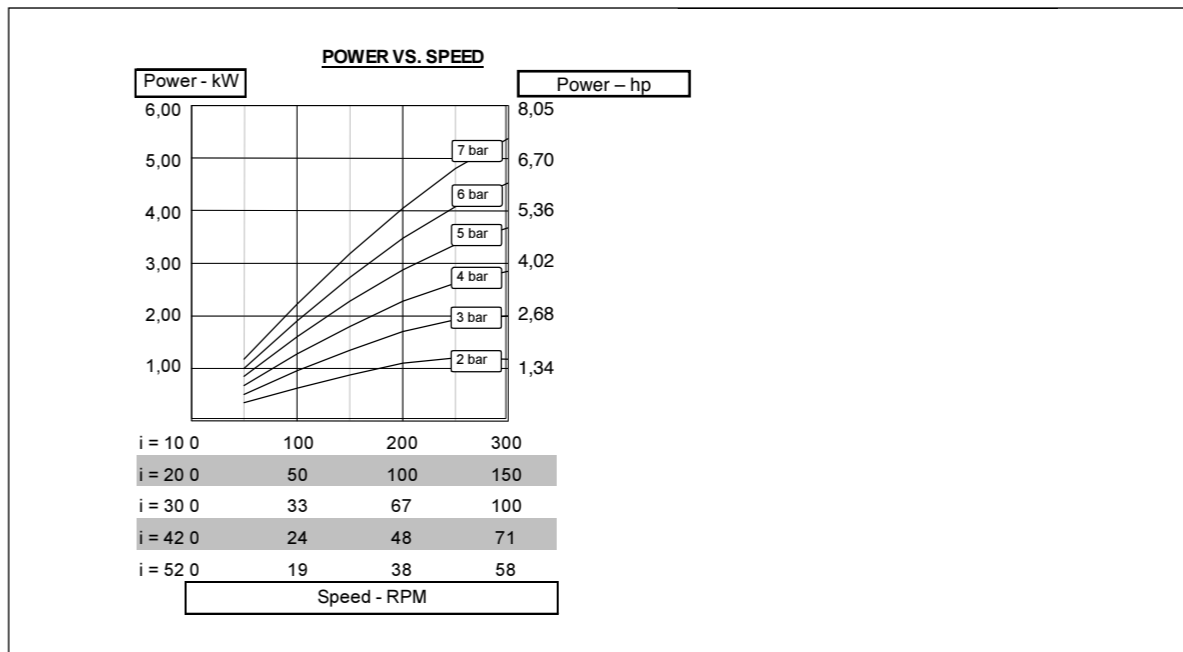
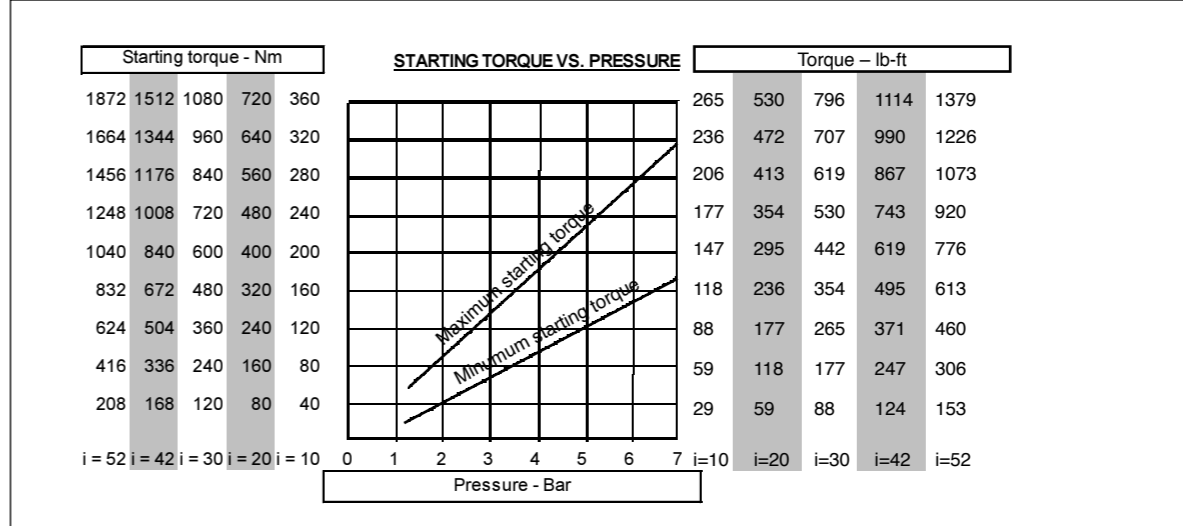
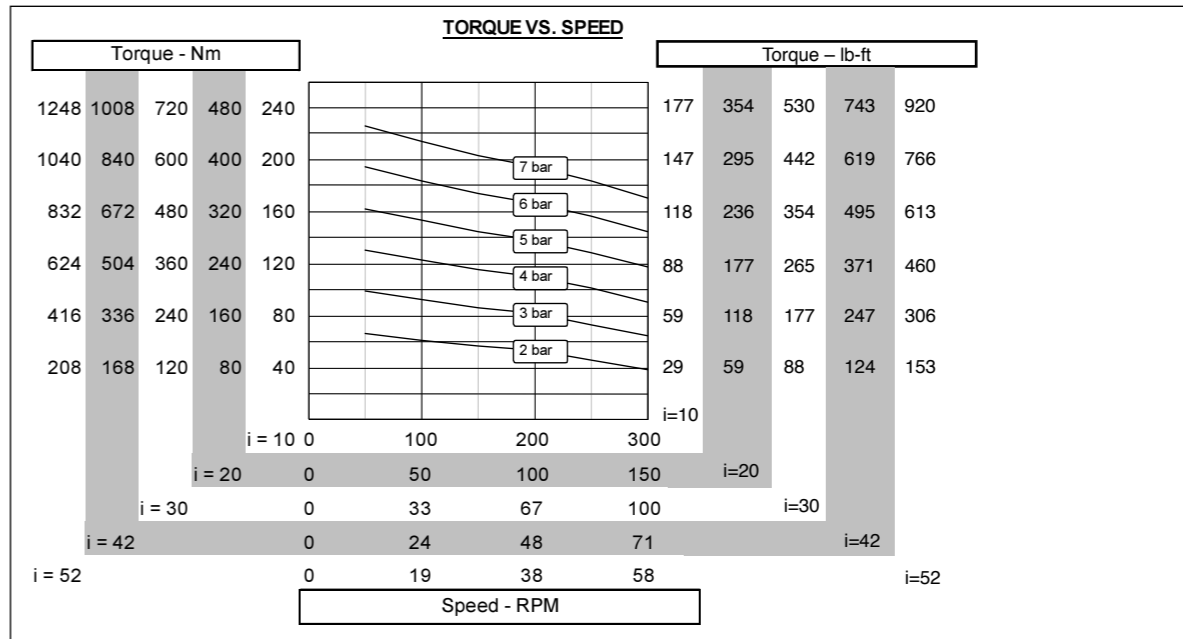

PERFORMANCES GLOBE VS10C AIR MOTOR WITH COAXIAL AND PLANETARY GEAR

RECOMMENDED GEARBOX LUBRICANTS

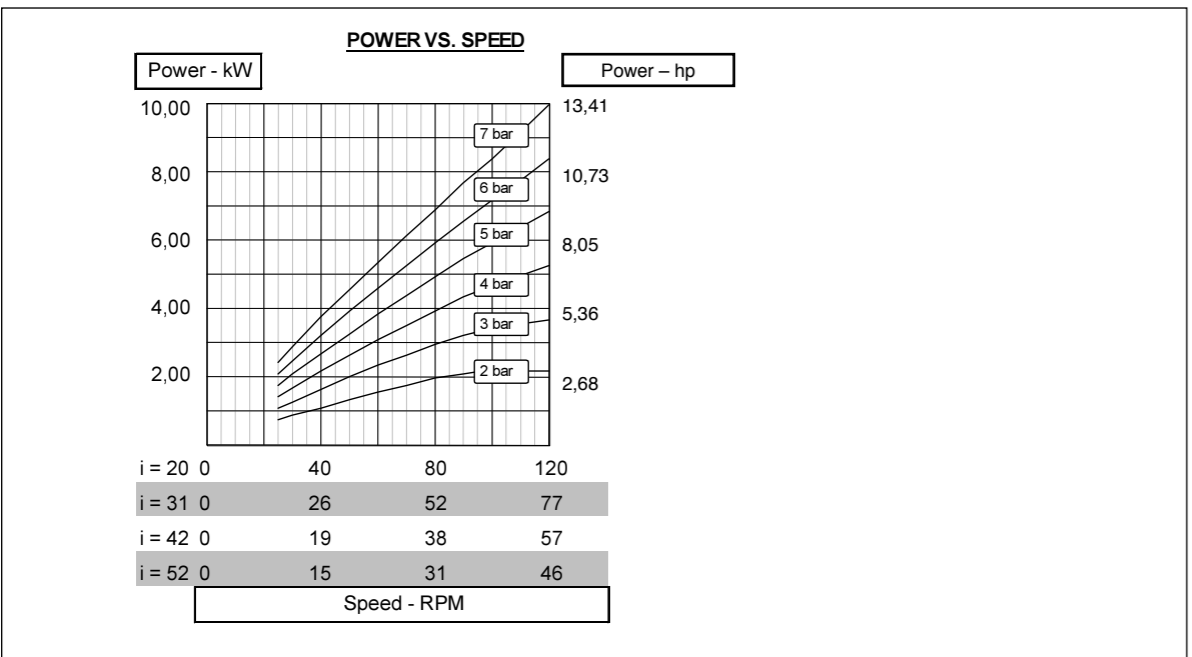
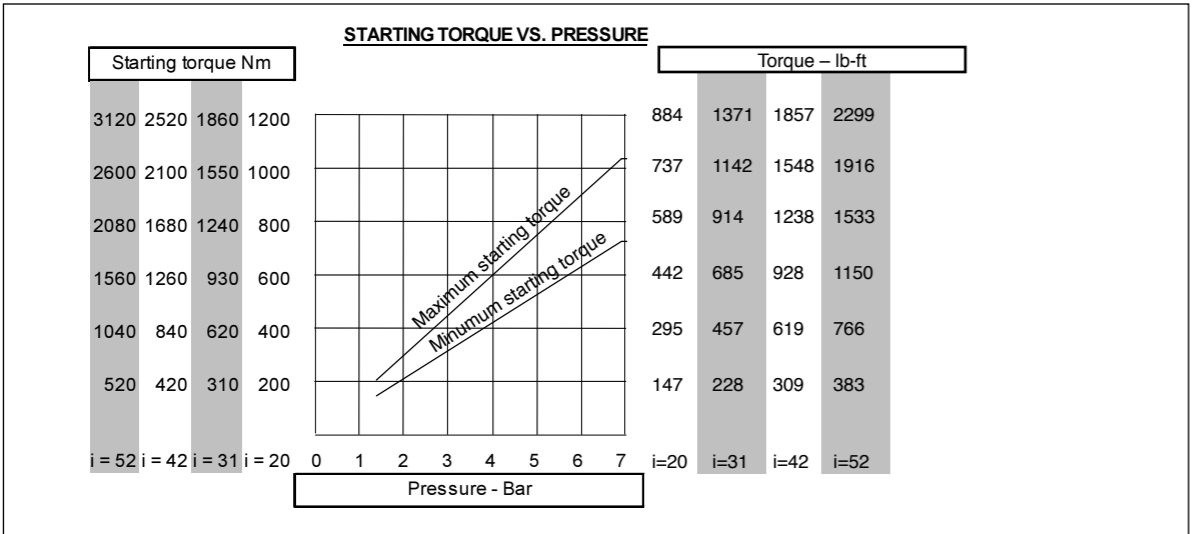
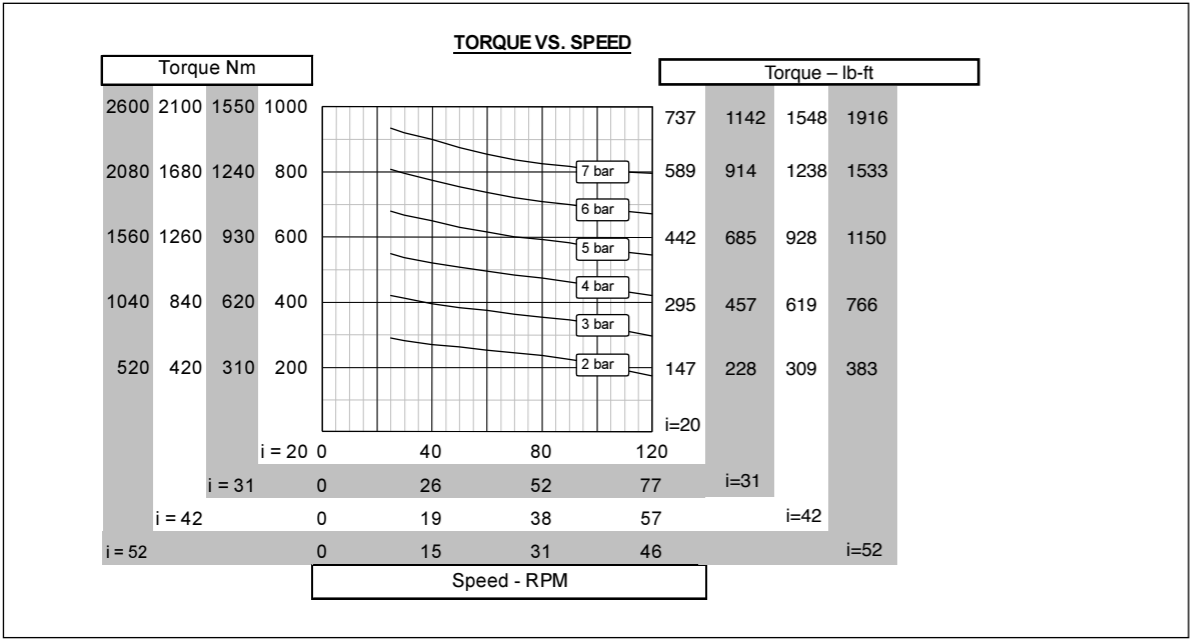

ISO VG	Ambient temperature (°C)	Synthetic oil			Mineral oil			
		460	220 320	150	680	460	320	220
Manufacturer	-15° to 100°	-	-25° to 80°	-30° to 70°	5° to 50°	5° to 45°	0° to 40°	0° to 35°
	AGIP	-	Telium VSF 320	Telium VSF 150	Blasia 680	Blasia 460	Blasia 320	Blasia 220
	BP	Energol SGXP 460	Energol SGXP 220	Energol SGXP 150	Energol GRXP 680	Energol GRXP 460	Energol GRXP 320	Energol GRXP 220
	ESSO	-	-	-	Spartan EP 680	Spartan EP 460	Spartan EP 320	Spartan EP 220
	SHELL	Tivela Oil SD	Tivela Oil WB	-	Omala Oil 680	Omala Oil 460	Omala Oil 320	Omala Oil 220
	KLÜBER	Syntheso D460 EP	Syntheso D220 EP	Syntheso D150 EP	Lamora 680	Lamora 460	Lamora 320	Lamora 220
	MOBIL	Glygoyle HE 460	Glygoyle 30	Glygoyle 22	Mobilgear 636	Mobilgear 636	Mobilgear 632	Mobilgear 630