

GS-8-V4A to GS-40-VA

Industrial Gas Springs – Push Type

With food grade oil according to FDA approval

Protection against corrosion and superior optics for even more sophisticated requirements: Based on ACE's industrial gas push type springs GS-8 to 40 made of steel, these models combine all advantages of stainless steel: they look great and are rust free. They are filled with food-grade oil as standard, which conforms to the requirements of FDA 21 CFR 178.3570.

These ACE gas push type springs do not only look good, they also are available in various stroke lengths and possible extension forces. A comprehensive range of accessories in stainless steel guarantees easy assembly and a broad range of uses.

ACE industrial gas pressure springs made of stainless steel are used in the automotive sector, in industrial applications, mechanical engineering and medical cleanroom technology as well as in the food, electronics and shipbuilding industries.

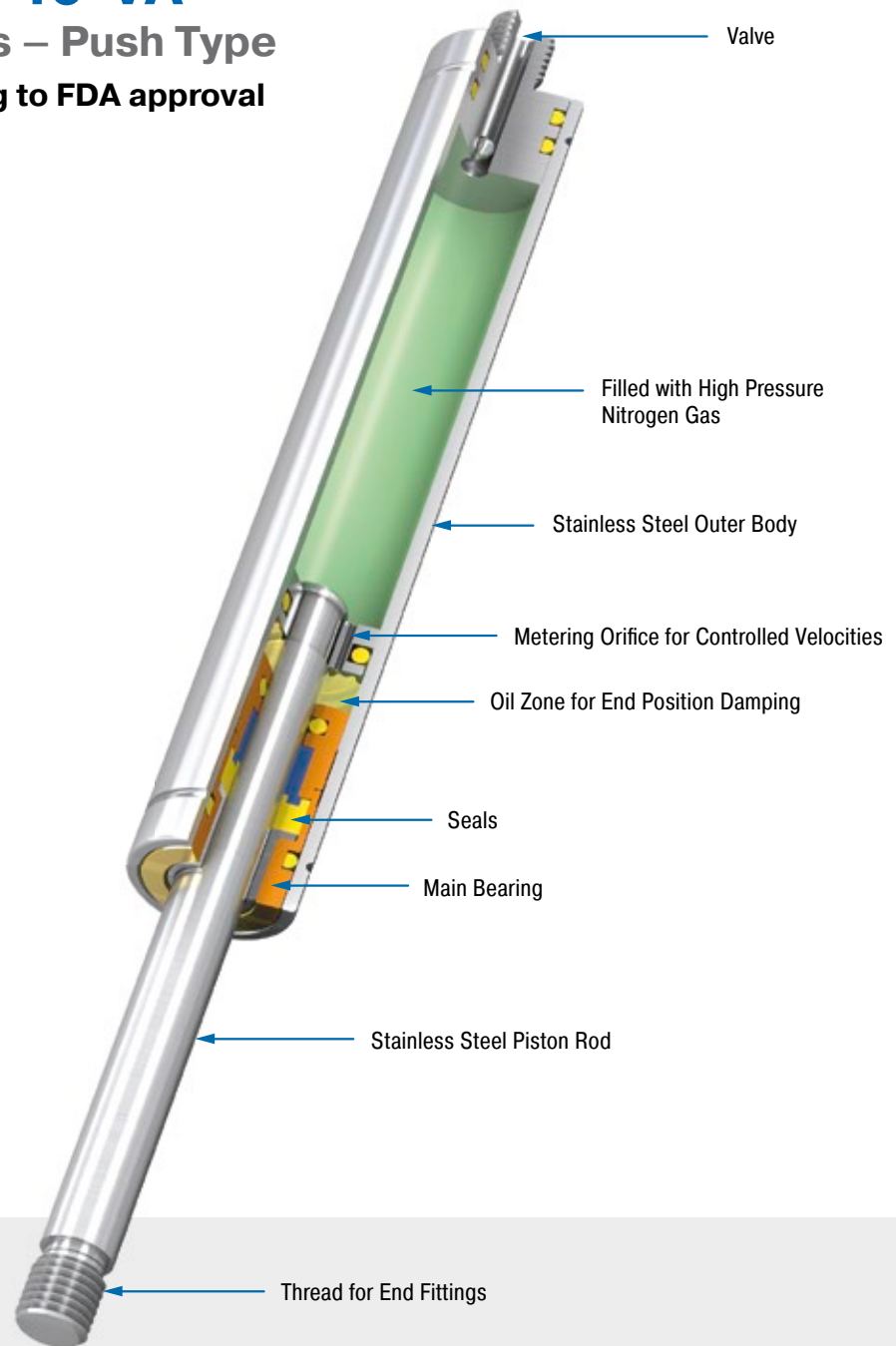

Technical Data

Force range: 10 N to 5,000 N

Piston rod diameter: Ø 3 mm to Ø 20 mm

Progression: Approx. 12 % to 40 %
(depending on size and stroke)

Lifetime: Approx. 10.000 m

Operating temperature range: -20 °C to +80 °C

Material: Outer body, Piston rod, End fittings:
Stainless steel (1.4301/1.4305, AISI 304/303
and 1.4404/1.4571, AISI 316L/316Ti)

Operating fluid: Nitrogen gas and HLP oil
according to DIN 51524, part 2

Mounting: We recommend mounting with piston rod downwards to take advantage of the built-in end position damping.

End position damping length: Approx.
5 mm to 30 mm (depending on the stroke)

Positive stop: External positive stop at the end of stroke provided by the customer.

Application field: Hoods, Shutters, Machine housing, Conveyor systems

Note: Special oil according to FDA 21 CFR 178.3570 of the food industry

End fittings: They are interchangeable and must be positively secured by the customer to prevent unscrewing.

Safety instructions: Gas pressure springs should not be installed under pre-tension.

On request: Special oils and other special options. Alternative accessories. Different end position damping and extension speed. Other gas springs material 1.4404/1.4571, AISI 316L/316Ti (V4A) available on request.

Valve Technology, Stainless Steel, Force range 10 N to 100 N (compressed up to 130 N)

End Fitting

Standard Dimensions

End Fitting

B3,5 M3.5x0.6

A3,5-V4A Radius R4

C3,5-V4A Ø13

D3,5-V4A Ø4

G3,5-V4A Ø13

Stroke

Ø3

Ø8

L +/- 2 mm extended

Stud Thread **B3,5**

Eye **A3,5-V4A**
max. force 370 N

Angle Ball Joint **C3,5-V4A**
max. force 370 N

Clevis Fork **D3,5-V4A**
max. force 370 N

Ball Socket **G3,5-V4A**
max. force 370 N

Adjuster Knob DE-GAS-3,5
See page 171.

| Performance and Dimensions | | | |
|----------------------------|--------------|------------------|-----------------------|
| TYPES | Stroke mm | L extended mm | Force Range max. N |
| GS-8-20-V4A | 20 | 72 | 100 |
| GS-8-30-V4A | 30 | 92 | 100 |
| GS-8-40-V4A | 40 | 112 | 100 |
| GS-8-50-V4A | 50 | 132 | 100 |
| GS-8-60-V4A | 60 | 152 | 100 |
| GS-8-80-V4A | 80 | 192 | 100 |

Ordering Example

GS-8-30-AC-30-V4A

Type (Push Type) _____

Body Ø (8 mm) _____

Stroke (30 mm) _____

Piston Rod End Fitting A3,5-V4A _____

Body End Fitting C3,5-V4A _____

Nominal Force F₁ 30 N _____

Material (1.4404/1.4571, AISI 316L/316Ti, V4A) _____

Mounting accessories see from page 202.

Technical Data

Force range: 10 N to 100 N (compressed up to 130 N)

Progression: Approx. 27 %

Operating temperature range: -20 °C to +80 °C

Material: Outer body, Piston rod, End fittings: Stainless steel (1.4404/1.4571, AISI 316L/316Ti)

Mounting: We recommend mounting with piston rod downwards to take advantage of the built-in end position damping.

End position damping length: Approx. 5 mm (depending on the stroke)

Positive stop: External positive stop at the end of stroke provided by the customer.

Note: Special oil according to FDA 21 CFR 178.3570 of the food industry

End fittings: They are interchangeable and must be positively secured by the customer to prevent unscrewing.

Safety instructions: Gas pressure springs should not be installed under pre-tension.

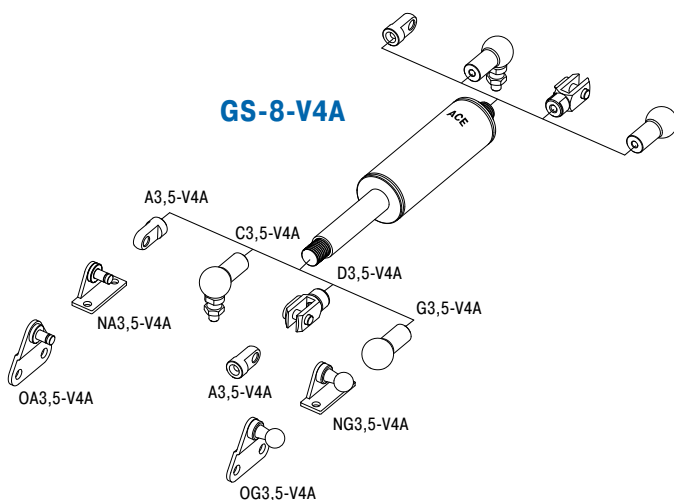

End Fitting

Standard Dimensions

End Fitting

B3,5

M3.5x0.6

Stroke

Ø3

5

A3,5-V4A

Radius R4

4.1

Ø8

8

6

11

C3,5-V4A

Ø13

Ø8

8.5

18

M4x0.7

36°

D3,5-V4A

Ø4

8

4

5

8

16

G3,5-V4A

Ø13

Ø8

4

Ø8

6

18

Performance and Dimensions

| TYPES | Stroke mm | L extended mm | Force Range max. N |
|--------------|-----------|---------------|--------------------|
| GS-10-20-V4A | 20 | 72 | 100 |
| GS-10-30-V4A | 30 | 92 | 100 |
| GS-10-40-V4A | 40 | 112 | 100 |
| GS-10-50-V4A | 50 | 132 | 100 |
| GS-10-60-V4A | 60 | 152 | 100 |
| GS-10-80-V4A | 80 | 192 | 100 |

Ordering Example

GS-10-30-AC-30-V4A

Type (Push Type) _____

Body Ø (10 mm) _____

Stroke (30 mm) _____

Piston Rod End Fitting A3,5-V4A _____

Body End Fitting C3,5-V4A _____

Nominal Force F₁ 30 N _____

Material (1.4404/1.4571, AISI 316L/316Ti, V4A) _____

Stud Thread **B3,5**

Eye **A3,5-V4A**
max. force 370 N

Angle Ball Joint **C3,5-V4A**
max. force 370 N

Clevis Fork **D3,5-V4A**
max. force 370 N

Ball Socket **G3,5-V4A**
max. force 370 N

Adjuster Knob **DE-GAS-3,5**
See page 171.

Mounting accessories see from page 202.

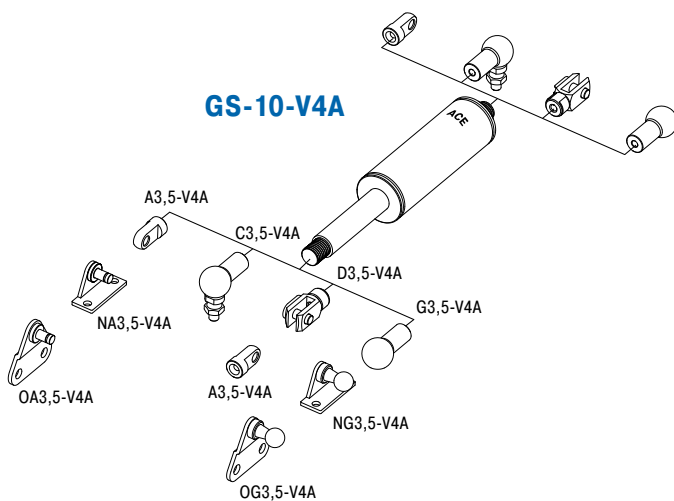

Technical Data

- Force range:** 10 N to 100 N (compressed up to 115 N)
- Progression:** Approx. 12 %
- Operating temperature range:** -20 °C to +80 °C
- Material:** Outer body, Piston rod, End fittings: Stainless steel (1.4404/1.4571, AISI 316L/316Ti)
- Mounting:** We recommend mounting with piston rod downwards to take advantage of the built-in end position damping.
- End position damping length:** Approx. 5 mm (depending on the stroke)
- Positive stop:** External positive stop at the end of stroke provided by the customer.
- Note:** Special oil according to FDA 21 CFR 178.3570 of the food industry
- End fittings:** They are interchangeable and must be positively secured by the customer to prevent unscrewing.
- Safety instructions:** Gas pressure springs should not be installed under pre-tension.

Issue 08.2016 – Specifications subject to change

Valve Technology, Stainless Steel, Force range 15 N to 180 N (compressed up to 212 N)

End Fitting

Standard Dimensions

End Fitting

B3,5

A3,5-V4A

C3,5-V4A

D3,5-V4A

G3,5-V4A

Performance and Dimensions

| TYPES | Stroke mm | L extended mm | Force Range max. N |
|---------------|--------------|------------------|-----------------------|
| GS-12-20-V4A | 20 | 72 | 180 |
| GS-12-30-V4A | 30 | 92 | 180 |
| GS-12-40-V4A | 40 | 112 | 180 |
| GS-12-50-V4A | 50 | 132 | 180 |
| GS-12-60-V4A | 60 | 152 | 180 |
| GS-12-80-V4A | 80 | 192 | 150 |
| GS-12-100-V4A | 100 | 232 | 150 |
| GS-12-120-V4A | 120 | 272 | 120 |
| GS-12-150-V4A | 150 | 332 | 100 |

Ordering Example **GS-12-100-AA-30-V4A**

Type (Push Type) _____

Body Ø (12 mm) _____

Stroke (100 mm) _____

Piston Rod End Fitting A3,5-V4A _____

Body End Fitting A3,5-V4A _____

Nominal Force F₁ 30 N _____

Material (1.4404/1.4571, AISI 316L/316Ti, V4A) _____

Mounting accessories see from page 202.

Stud Thread B3,5

Eye A3,5-V4A
max. force 370 N

Angle Ball Joint C3,5-V4A
max. force 370 N

Clevis Fork D3,5-V4A
max. force 370 N

Ball Socket G3,5-V4A
max. force 370 N

Adjuster Knob DE-GAS-3,5
See page 171.

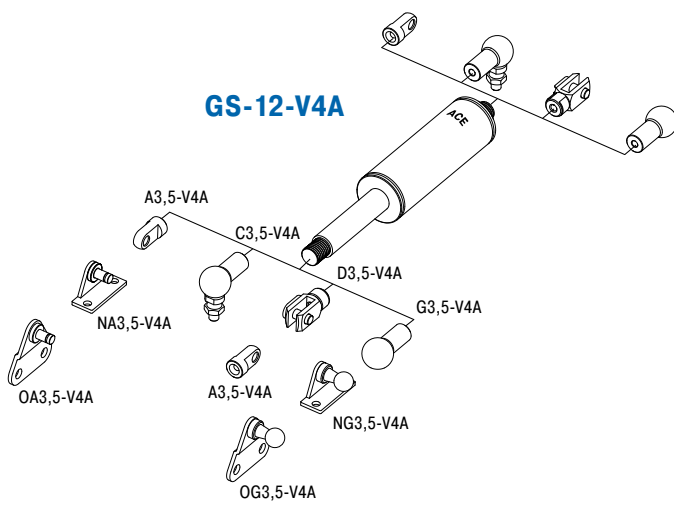

Technical Data

- Force range:** 15 N to 180 N (compressed up to 212 N)
- Progression:** Approx. 18 %
- Operating temperature range:** -20 °C to +80 °C
- Material:** Outer body, Piston rod, End fittings: Stainless steel (1.4404/1.4571, AISI 316L/316Ti)
- Mounting:** We recommend mounting with piston rod downwards to take advantage of the built-in end position damping.
- End position damping length:** Approx. 10 mm (depending on the stroke)
- Positive stop:** External positive stop at the end of stroke provided by the customer.
- Note:** Special oil according to FDA 21 CFR 178.3570 of the food industry
- End fittings:** They are interchangeable and must be positively secured by the customer to prevent unscrewing.
- Safety instructions:** Gas pressure springs should not be installed under pre-tension.

Issue 08.2016 – Specifications subject to change

End Fitting

Standard Dimensions

End Fitting

B5

A5-VA

C5-VA

D5-VA

E5-VA

G5-VA

Rod Shroud W5-15-VA

Performance and Dimensions

| TYPES | Stroke mm | L extended mm | Force Range max. N |
|--------------|-----------|---------------|--------------------|
| GS-15-20-VA | 20 | 74 | 400 |
| GS-15-40-VA | 40 | 114 | 400 |
| GS-15-50-VA | 50 | 134 | 400 |
| GS-15-60-VA | 60 | 154 | 400 |
| GS-15-80-VA | 80 | 194 | 400 |
| GS-15-100-VA | 100 | 234 | 400 |
| GS-15-120-VA | 120 | 274 | 400 |
| GS-15-150-VA | 150 | 334 | 400 |

Ordering Example

GS-15-150-AC-150-VA

Type (Push Type) _____

Body Ø (15.6 mm) _____

Stroke (150 mm) _____

Piston Rod End Fitting A5-VA _____

Body End Fitting C5-VA _____

Nominal Force F₁ 150 N _____

Material (1.4301/1.4305, AISI 304/303, VA) _____

Stud Thread B5

Eye A5-VA
max. force 490 N

Angle Ball Joint C5-VA
max. force 430 N

Clevis Fork D5-VA
max. force 490 N

Swivel Eye E5-VA
max. force 490 N

Ball Socket G5-VA
max. force 430 N

Adjuster Knob DE-GAS-5
See page 171.

Mounting accessories see from page 202.

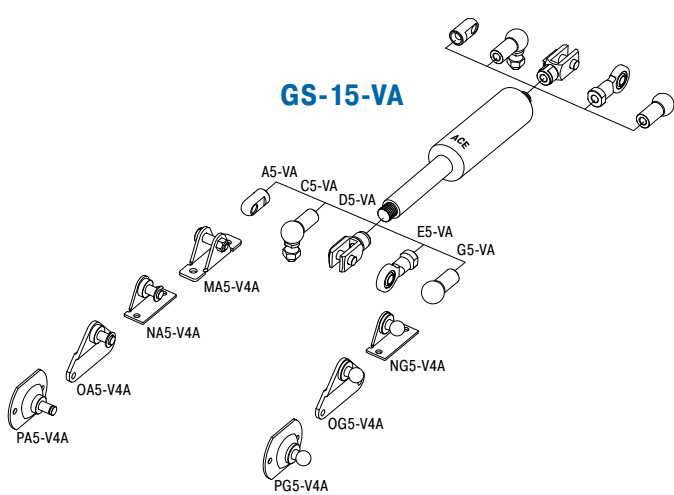

Technical Data

- Force range:** 40 N to 400 N (compressed up to 535 N)
- Progression:** Approx. 34 %
- Operating temperature range:** -20 °C to +80 °C
- Material:** Outer body, Piston rod, End fittings: Stainless steel (1.4301/1.4305, AISI 304/303)
- Mounting:** We recommend mounting with piston rod downwards to take advantage of the built-in end position damping.
- End position damping length:** Approx. 20 mm (depending on the stroke)
- Positive stop:** External positive stop at the end of stroke provided by the customer.
- Note:** Special oil according to FDA 21 CFR 178.3570 of the food industry
- End fittings:** They are interchangeable and must be positively secured by the customer to prevent unscrewing.
- Safety instructions:** Gas pressure springs should not be installed under pre-tension.

Valve Technology, Stainless Steel, Force range 50 N to 700 N (compressed up to 930 N)

End Fitting

Standard Dimensions

End Fitting

B8 Stud Thread **B8**

A8-VA Eye **A8-VA**
max. force 1,560 N

C8-VA Angle Ball Joint **C8-VA**
max. force 1,140 N

D8-VA Clevis Fork **D8-VA**
max. force 1,560 N

E8-VA Swivel Eye **E8-VA**
max. force 1,560 N

G8-VA Ball Socket **G8-VA**
max. force 1,140 N

Adjuster Knob DE-GAS-8
See page 171.

Performance and Dimensions

| TYPES | Stroke mm | L extended mm | Force Range max. N |
|--------------|-----------|---------------|--------------------|
| GS-19-50-VA | 50 | 164 | 700 |
| GS-19-100-VA | 100 | 264 | 700 |
| GS-19-150-VA | 150 | 364 | 700 |
| GS-19-200-VA | 200 | 464 | 700 |
| GS-19-250-VA | 250 | 564 | 700 |
| GS-19-300-VA | 300 | 664 | 700 |

Ordering Example

GS-19-150-AC-600-VA

Type (Push Type) _____
 Body Ø (19 mm) _____
 Stroke (150 mm) _____
 Piston Rod End Fitting A8-VA _____
 Body End Fitting C8-VA _____
 Nominal Force F₁ 600 N _____
 Material (1.4301/1.4305, AISI 304/303, VA) _____

Mounting accessories see from page 202.

Rod Shroud W8-19-VA
L = Stroke + 30

Technical Data

Force range: 50 N to 700 N (compressed up to 930 N)

Progression: Approx. 33 %

Operating temperature range: -20 °C to +80 °C

Material: Outer body, Piston rod, End fittings: Stainless steel (1.4301/1.4305, AISI 304/303)

Mounting: We recommend mounting with piston rod downwards to take advantage of the built-in end position damping.

End position damping length: Approx. 20 mm (depending on the stroke)

Positive stop: External positive stop at the end of stroke provided by the customer.

Note: Special oil according to FDA 21 CFR 178.3570 of the food industry

End fittings: They are interchangeable and must be positively secured by the customer to prevent unscrewing.

Safety instructions: Gas pressure springs should not be installed under pre-tension.

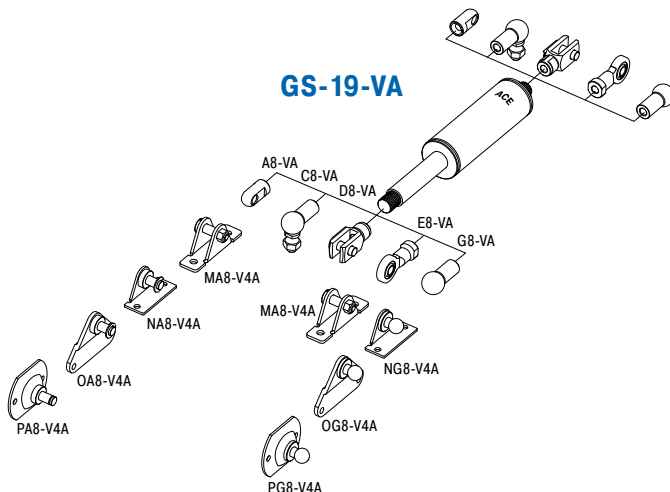

End Fitting

Standard Dimensions

End Fitting

Performance and Dimensions

| TYPES | Stroke mm | L extended mm | Force Range max. N |
|--------------|-----------|---------------|--------------------|
| GS-22-50-VA | 50 | 164 | 1,200 |
| GS-22-100-VA | 100 | 264 | 1,200 |
| GS-22-150-VA | 150 | 364 | 1,200 |
| GS-22-200-VA | 200 | 464 | 1,200 |
| GS-22-250-VA | 250 | 564 | 1,200 |
| GS-22-300-VA | 300 | 664 | 1,200 |
| GS-22-350-VA | 350 | 764 | 1,200 |
| GS-22-400-VA | 400 | 864 | 1,200 |
| GS-22-450-VA | 450 | 964 | 1,200 |
| GS-22-500-VA | 500 | 1,064 | 1,200 |
| GS-22-550-VA | 550 | 1,164 | 1,200 |
| GS-22-600-VA | 600 | 1,264 | 1,200 |
| GS-22-650-VA | 650 | 1,364 | 1,200 |
| GS-22-700-VA | 700 | 1,464 | 1,200 |

Ordering Example

GS-22-150-AE-800-VA

Type (Push Type) _____
 Body Ø (23 mm) _____
 Stroke (150 mm) _____
 Piston Rod End Fitting A8-VA _____
 Body End Fitting E8-VA _____
 Nominal Force F₁ 800 N _____
 Material (1.4301/1.4305, AISI 304/303, VA) _____

Mounting accessories see from page 202.

Adjuster Knob DE-GAS-8
See page 171.

End Fitting Options:
 Stud Thread B8
 Eye A8-VA max. force 1,560 N
 Angle Ball Joint C8-VA max. force 1,140 N
 Clevis Fork D8-VA max. force 1,560 N
 Swivel Eye E8-VA max. force 1,560 N
 Ball Socket G8-VA max. force 1,140 N

Rod Shroud W8-22-VA
L = Stroke + 30

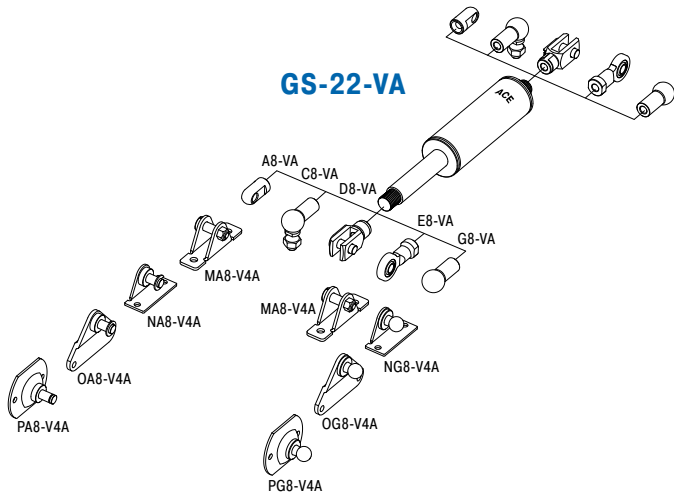

Technical Data

- Force range:** 100 N to 1,200 N (compressed up to 1,585 N)
- Progression:** Approx. 32 %
- Operating temperature range:** -20 °C to +80 °C
- Material:** Outer body, Piston rod, End fittings: Stainless steel (1.4301/1.4305, AISI 304/303)
- Mounting:** We recommend mounting with piston rod downwards to take advantage of the built-in end position damping.
- End position damping length:** Approx. 20 mm (depending on the stroke)
- Positive stop:** External positive stop at the end of stroke provided by the customer.
- Note:** Special oil according to FDA 21 CFR 178.3570 of the food industry
- End fittings:** They are interchangeable and must be positively secured by the customer to prevent unscrewing.
- Safety instructions:** Gas pressure springs should not be installed under pre-tension.

Issue 08.2016 – Specifications subject to change

Valve Technology, Stainless Steel, Force range 150 N to 2,500 N (compressed up to 3,800 N)

End Fitting

Standard Dimensions

End Fitting

B10

M10x1.5

Ø 14

Stroke

Ø 28

12

L +/- 2 mm extended

12

Performance and Dimensions

| TYPES | Stroke mm | L extended mm | Force Range max. N |
|--------------|--------------|------------------|-----------------------|
| GS-28-100-VA | 100 | 262 | 2,500 |
| GS-28-150-VA | 150 | 362 | 2,500 |
| GS-28-200-VA | 200 | 462 | 2,500 |
| GS-28-250-VA | 250 | 562 | 2,500 |
| GS-28-300-VA | 300 | 662 | 2,500 |
| GS-28-350-VA | 350 | 762 | 2,500 |
| GS-28-400-VA | 400 | 862 | 2,500 |
| GS-28-450-VA | 450 | 962 | 2,500 |
| GS-28-500-VA | 500 | 1,062 | 2,500 |
| GS-28-550-VA | 550 | 1,162 | 2,500 |
| GS-28-600-VA | 600 | 1,262 | 2,500 |
| GS-28-650-VA | 650 | 1,362 | 2,500 |

Stud Thread B10

Eye A10-VA
max. force 3,800 N

Angle Ball Joint C10-VA
max. force 1,750 N

Clevis Fork D10-VA
max. force 3,800 N

Swivel Eye E10-VA
max. force 3,800 N

Ordering Example **GS-28-150-EE-1200-VA**

Type (Push Type) _____

Body Ø (28 mm) _____

Stroke (150 mm) _____

Piston Rod End Fitting E10-VA _____

Body End Fitting E10-VA _____

Nominal Force F₁ 1200 N _____

Material (1.4301/1.4305, AISI 304/303, VA) _____

Mounting accessories see from page 202.

Adjuster Knob DE-GAS-10
See page 171.

Rod Shroud W10-28-VA

Ø 32

L = Stroke + 40

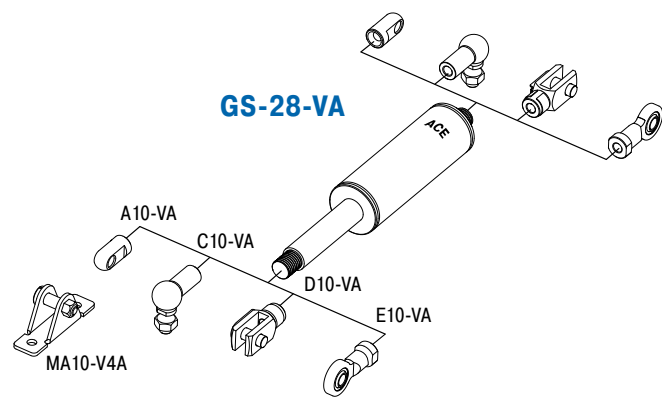

Technical Data

Force range: 150 N to 2,500 N (compressed up to 3,800 N)

Progression: Approx. 52 %

Operating temperature range: -20 °C to +80 °C

Material: Outer body, Piston rod, End fittings: Stainless steel (1.4301/1.4305, AISI 304/303)

Mounting: We recommend mounting with piston rod downwards to take advantage of the built-in end position damping.

End position damping length: Approx. 20 mm (depending on the stroke)

Positive stop: External positive stop at the end of stroke provided by the customer.

Note: Special oil according to FDA 21 CFR 178.3570 of the food industry

End fittings: They are interchangeable and must be positively secured by the customer to prevent unscrewing.

Safety instructions: Gas pressure springs should not be installed under pre-tension.

End Fitting

Standard Dimensions

End Fitting

B14 Stud Thread **B14**

A14-VA Eye **A14-VA**
max. force 7,000 N

C14-VA Angle Ball Joint **C14-VA**
max. force 3,200 N

D14-VA Clevis Fork **D14-VA**
max. force 7,000 N

E14-VA Swivel Eye **E14-VA**
max. force 7,000 N

Rod Shroud W14-40-VA

Adjuster Knob DE-GAS-14
See page 171.

| Performance and Dimensions | | | |
|----------------------------|-----------|---------------|--------------------|
| TYPES | Stroke mm | L extended mm | Force Range max. N |
| GS-40-100-VA | 100 | 317 | 5,000 |
| GS-40-150-VA | 150 | 417 | 5,000 |
| GS-40-200-VA | 200 | 517 | 5,000 |
| GS-40-300-VA | 300 | 717 | 5,000 |
| GS-40-400-VA | 400 | 917 | 5,000 |
| GS-40-500-VA | 500 | 1,117 | 5,000 |
| GS-40-600-VA | 600 | 1,317 | 5,000 |

Ordering Example **GS-40-150-DD-3500-VA**

Type (Push Type) _____
 Body Ø (40 mm) _____
 Stroke (150 mm) _____
 Piston Rod End Fitting D14-VA _____
 Body End Fitting D14-VA _____
 Nominal Force F₁ 3500 N _____
 Material (1.4301/1.4305, AISI 304/303, VA) _____

Mounting accessories see from page 202.

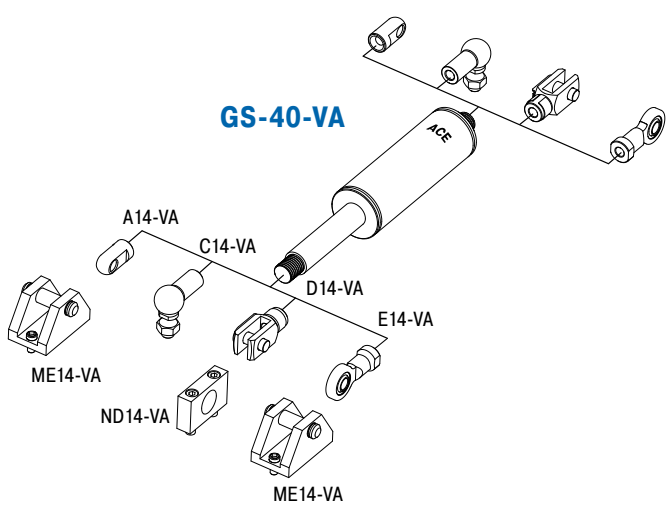

Technical Data

- Force range:** 500 N to 5,000 N (compressed up to 7,000 N)
- Progression:** Approx. 40 %
- Operating temperature range:** -20 °C to +80 °C
- Material:** Outer body, Piston rod, End fittings: Stainless steel (1.4301/1.4305, AISI 304/303)
- Mounting:** We recommend mounting with piston rod downwards to take advantage of the built-in end position damping.
- End position damping length:** Approx. 30 mm (depending on the stroke)
- Positive stop:** External positive stop at the end of stroke provided by the customer.
- Note:** Special oil according to FDA 21 CFR 178.3570 of the food industry
- End fittings:** They are interchangeable and must be positively secured by the customer to prevent unscrewing.
- Safety instructions:** Gas pressure springs should not be installed under pre-tension.

Issue 08.2016 – Specifications subject to change

Further Stainless Steel Gas Springs (Push Type), V4A

| Performance | | | |
|--------------------|--------------|------------------|------------------------|
| TYPES | Stroke mm | L extended mm | Dimensions see Page |
| GS-15-20-V4A | 20 | 74 | 144 |
| GS-15-40-V4A | 40 | 114 | 144 |
| GS-15-50-V4A | 50 | 134 | 144 |
| GS-15-60-V4A | 60 | 154 | 144 |
| GS-15-80-V4A | 80 | 194 | 144 |
| GS-15-100-V4A | 100 | 234 | 144 |
| GS-15-120-V4A | 120 | 274 | 144 |
| GS-15-150-V4A | 150 | 334 | 144 |
| GS-19-50-V4A | 50 | 164 | 145 |
| GS-19-100-V4A | 100 | 264 | 145 |
| GS-19-150-V4A | 150 | 364 | 145 |
| GS-19-200-V4A | 200 | 464 | 145 |
| GS-19-250-V4A | 250 | 564 | 145 |
| GS-19-300-V4A | 300 | 664 | 145 |
| GS-22-50-V4A | 50 | 164 | 146 |
| GS-22-100-V4A | 100 | 264 | 146 |
| GS-22-150-V4A | 150 | 364 | 146 |
| GS-22-200-V4A | 200 | 464 | 146 |
| GS-22-250-V4A | 250 | 564 | 146 |
| GS-22-300-V4A | 300 | 664 | 146 |
| GS-22-350-V4A | 350 | 764 | 146 |
| GS-22-400-V4A | 400 | 864 | 146 |
| GS-22-450-V4A | 450 | 964 | 146 |
| GS-22-500-V4A | 500 | 1,064 | 146 |
| GS-22-550-V4A | 550 | 1,164 | 146 |
| GS-22-600-V4A | 600 | 1,264 | 146 |
| GS-22-650-V4A | 650 | 1,364 | 146 |
| GS-22-700-V4A | 700 | 1,464 | 146 |
| GS-28-100-V4A | 100 | 262 | 147 |
| GS-28-150-V4A | 150 | 362 | 147 |
| GS-28-200-V4A | 200 | 462 | 147 |
| GS-28-250-V4A | 250 | 562 | 147 |
| GS-28-300-V4A | 300 | 662 | 147 |
| GS-28-350-V4A | 350 | 762 | 147 |
| GS-28-400-V4A | 400 | 862 | 147 |
| GS-28-450-V4A | 450 | 962 | 147 |
| GS-28-500-V4A | 500 | 1,062 | 147 |
| GS-28-550-V4A | 550 | 1,162 | 147 |
| GS-28-600-V4A | 600 | 1,262 | 147 |
| GS-28-650-V4A | 650 | 1,362 | 147 |
| GS-40-100-V4A | 100 | 317 | 148 |
| GS-40-150-V4A | 150 | 417 | 148 |
| GS-40-200-V4A | 200 | 517 | 148 |
| GS-40-300-V4A | 300 | 717 | 148 |
| GS-40-400-V4A | 400 | 917 | 148 |
| GS-40-500-V4A | 500 | 1,117 | 148 |
| GS-40-600-V4A | 600 | 1,317 | 148 |

Further Stainless Steel Accessories, V4A

| End Fittings | | End Fittings | |
|---------------------|------------------------|---------------------|------------------------|
| TYPES | Dimensions see Page | TYPES | Dimensions see Page |
| A5-V4A | 204 | A10-V4A | 206 |
| C5-V4A | 204 | C10-V4A | 206 |
| D5-V4A | 204 | D10-V4A | 206 |
| E5-V4A | 204 | E10-V4A | 206 |
| G5-V4A | 204 | A14-V4A | 206 |
| A8-V4A | 205 | C14-V4A | 206 |
| C8-V4A | 205 | D14-V4A | 206 |
| D8-V4A | 205 | E14-V4A | 206 |
| E8-V4A | 205 | | |
| G8-V4A | 206 | | |